

Инструкция

Пресс-машина/разгибание спины Spirit Fitness DWS172-U2

Полезные ссылки:

[Пресс-машина/разгибание спины Spirit Fitness DWS172-U2 - смотреть на сайте](#)

[Пресс-машина/разгибание спины Spirit Fitness DWS172-U2 - читать отзывы](#)



SPIRIT FITNESS

A Heritage of Quality | The Spirit of Innovation

Инструкция по сборке. Пресс машина / Разгибание спины



Руководство пользователя



A Heritage of Quality | The Spirit of Innovation
SPIRIT FITNESS



A Heritage of Quality | The Spirit of Innovation
SPIRIT FITNESS



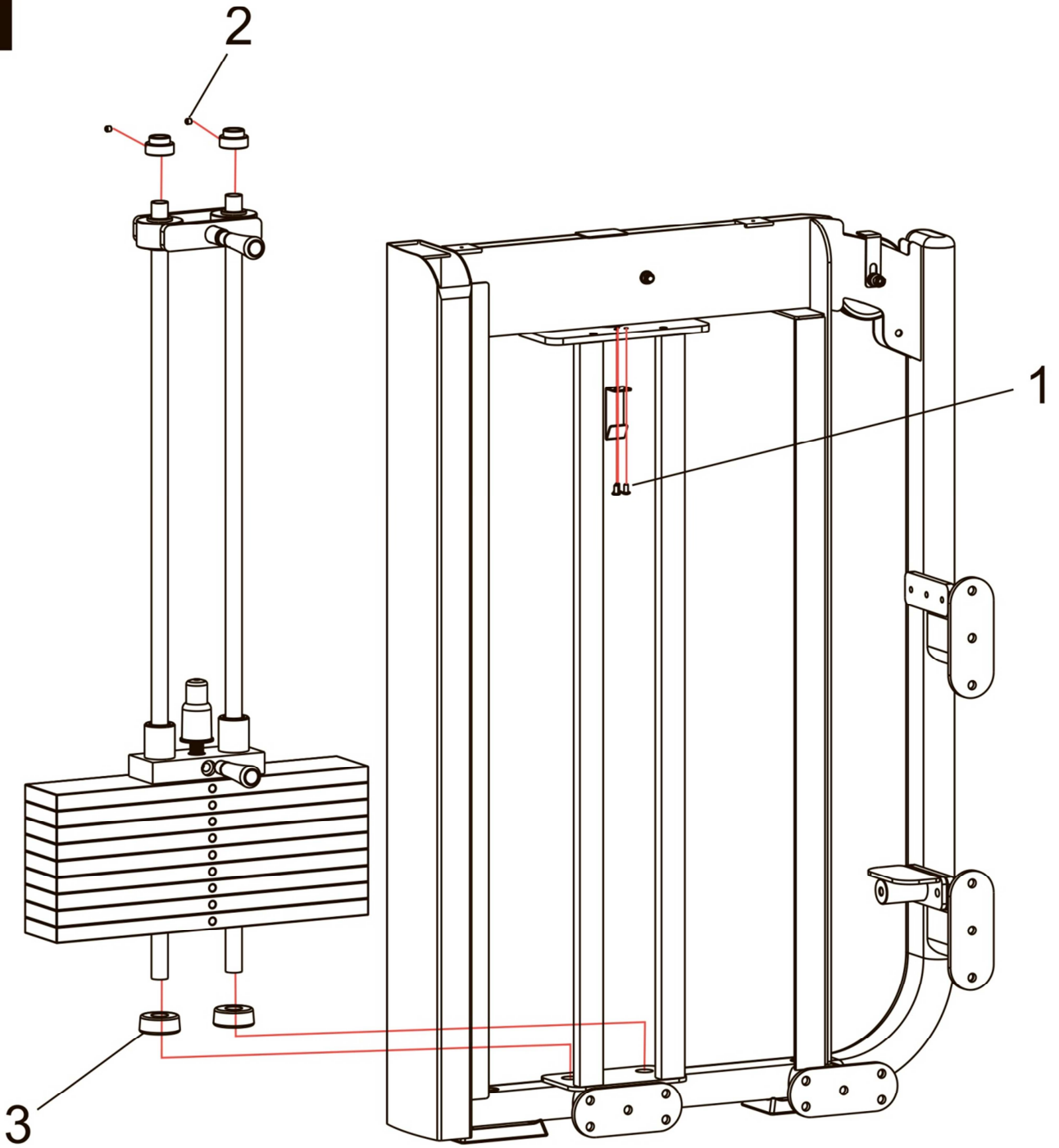

A Heritage of Quality | The Spirit of Innovation
SPIRIT FITNESS

1





1  X3
M6X12 

2  X2
M8X10 

3  X2
 $\Phi 62 \times \Phi 26 \times 25$

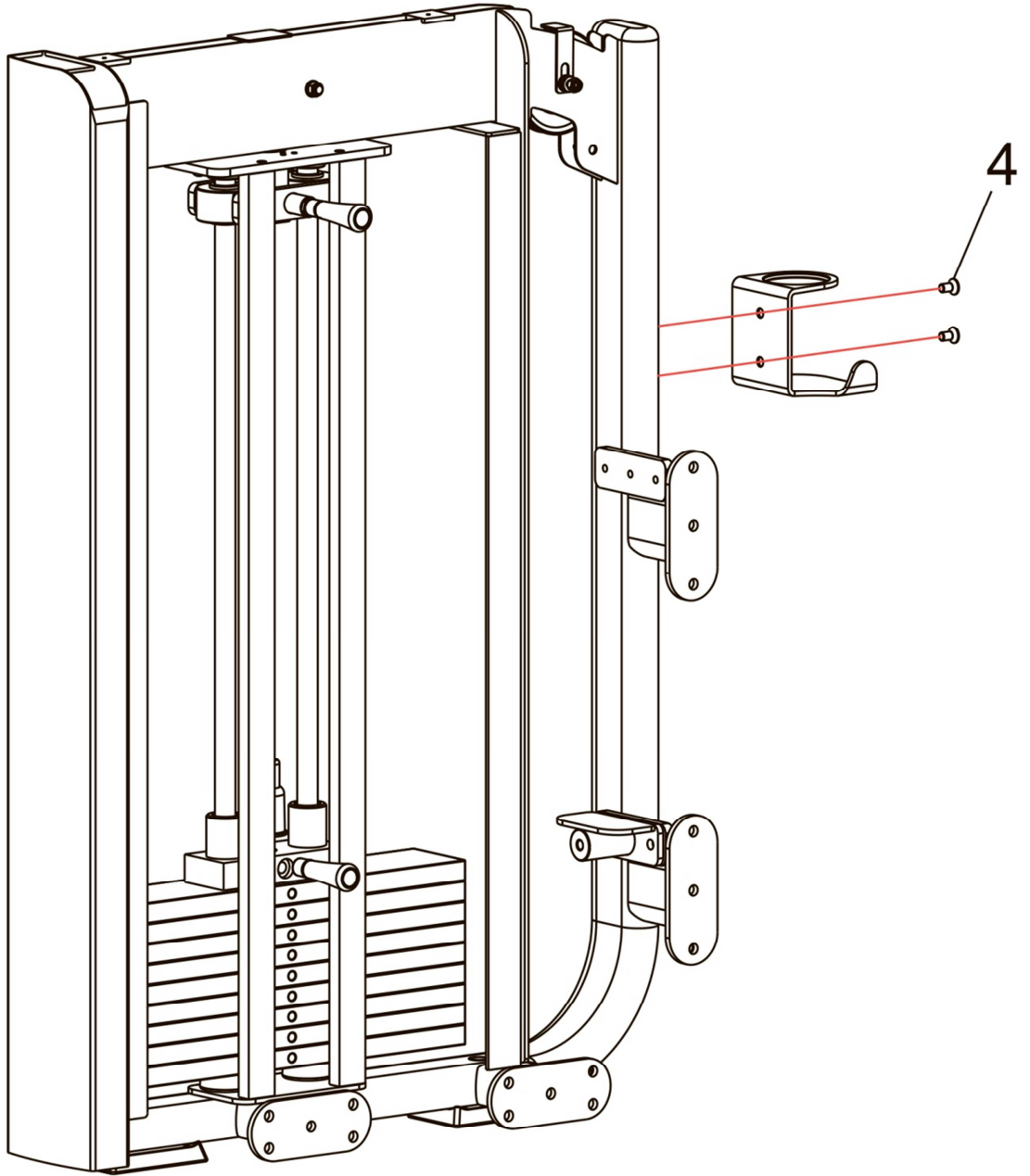
2







4  X2

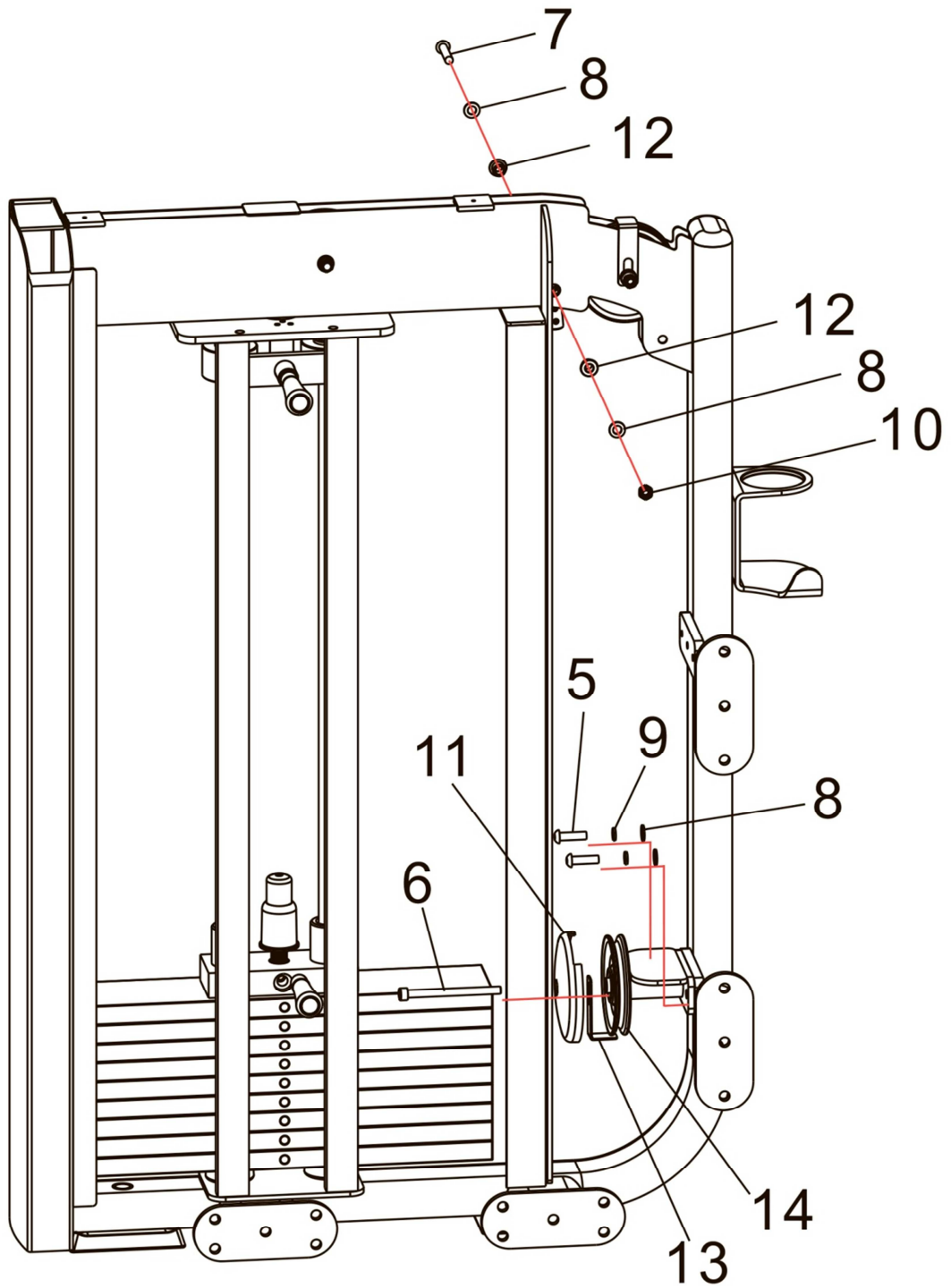

M10X20 

3



5  X2
M10X25 

6  X1
M10X50 

7  X1
M10X50 

8  X4
M10 

9  X2
M10 

10  X1
M10 

11  X1
 $\Phi 127$

12  X2
 $\Phi 22 \times \Phi 10.5 \times 13.5$



13  X 1
(35+80)*25*2

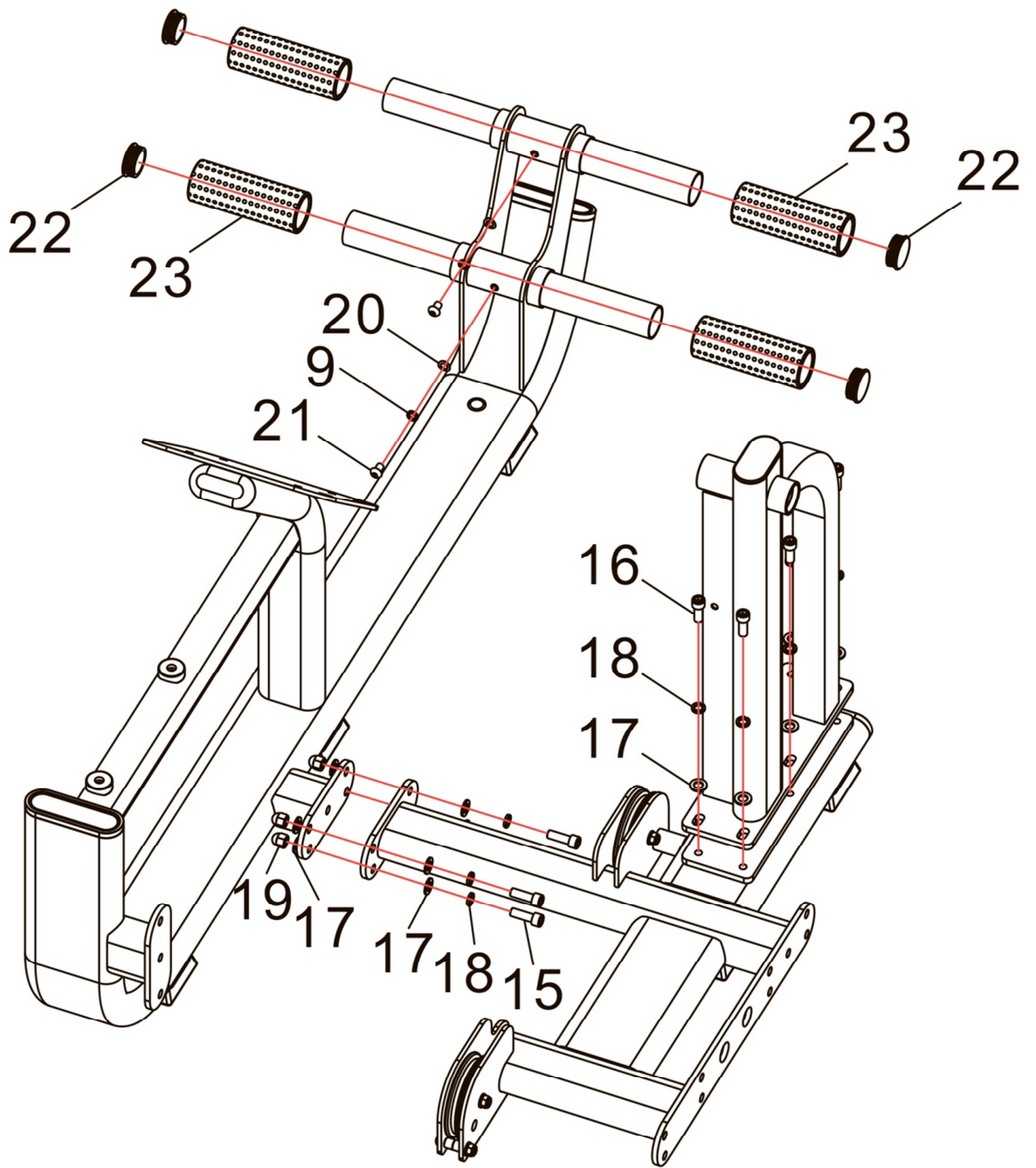

14  X1
 $\Phi 127$

4



9  X2
M10 

15  X4
M12X35 



16  X6
M12X30 

17  X14
M12 



18  X10
M12 

19  X4
M12 

20  X2
M10 

21  X2
M10X20 

22  X4
 $\Phi 50 \times 2.5$ 

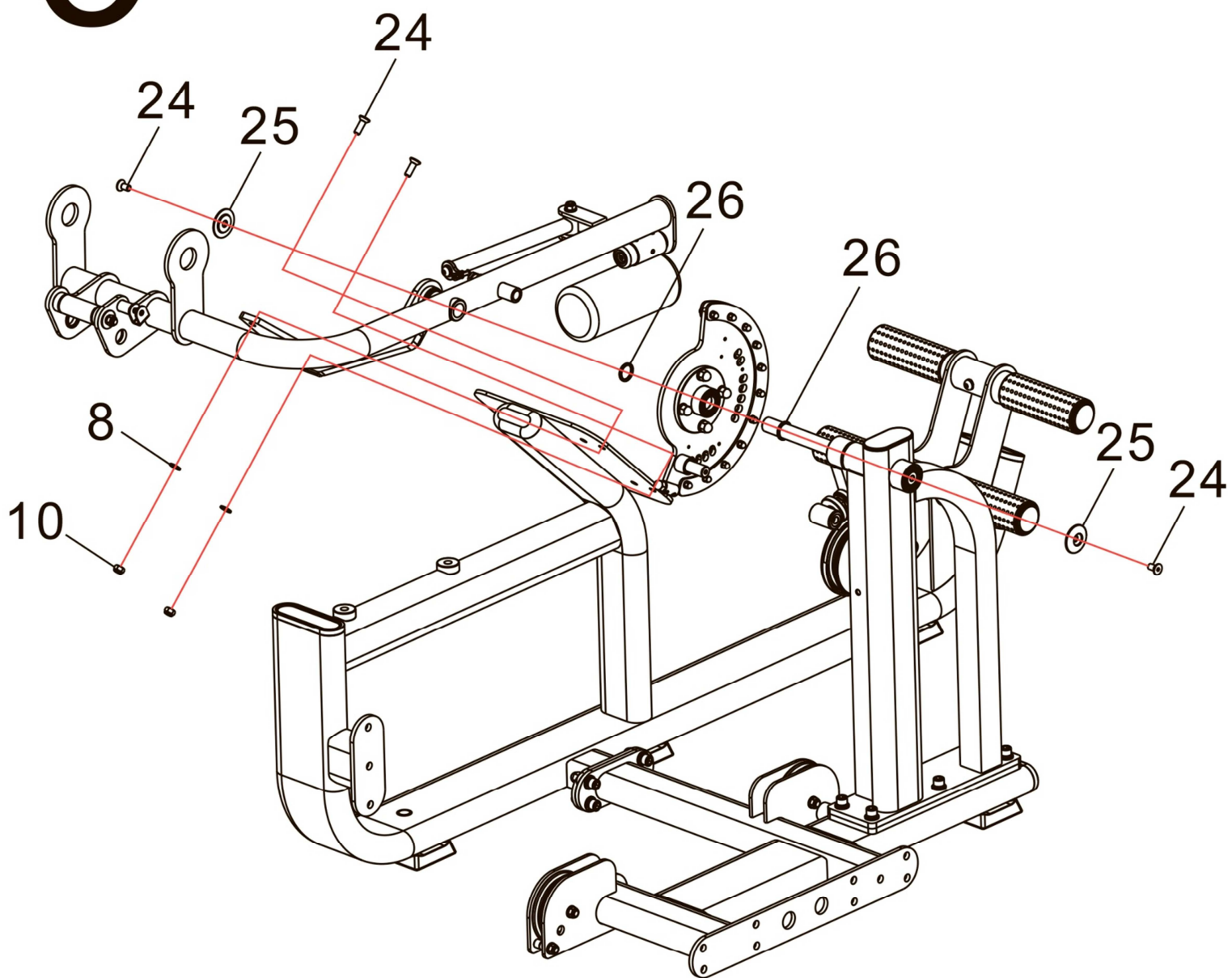

23  X4
 $\Phi 49 \times \Phi 61 \times 350$ 

5



8  X2
M10 

10  X2
M10 

24  X4
M10X30 



25  X2
Φ50

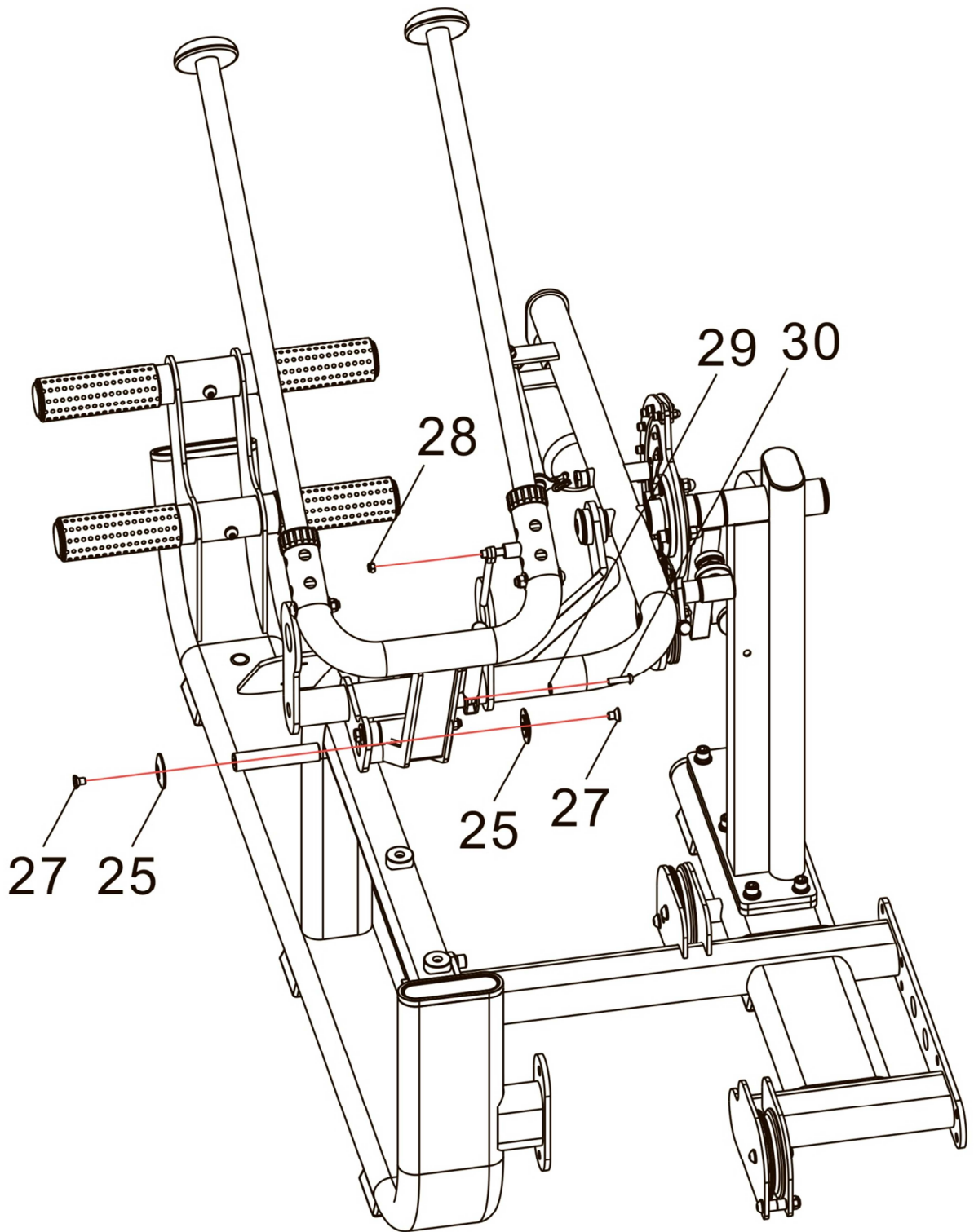

26  X2
Φ31.5*Φ26*3

6



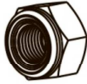

25  X2
Φ50

27  X2
M10X15 



28  X1
M8 

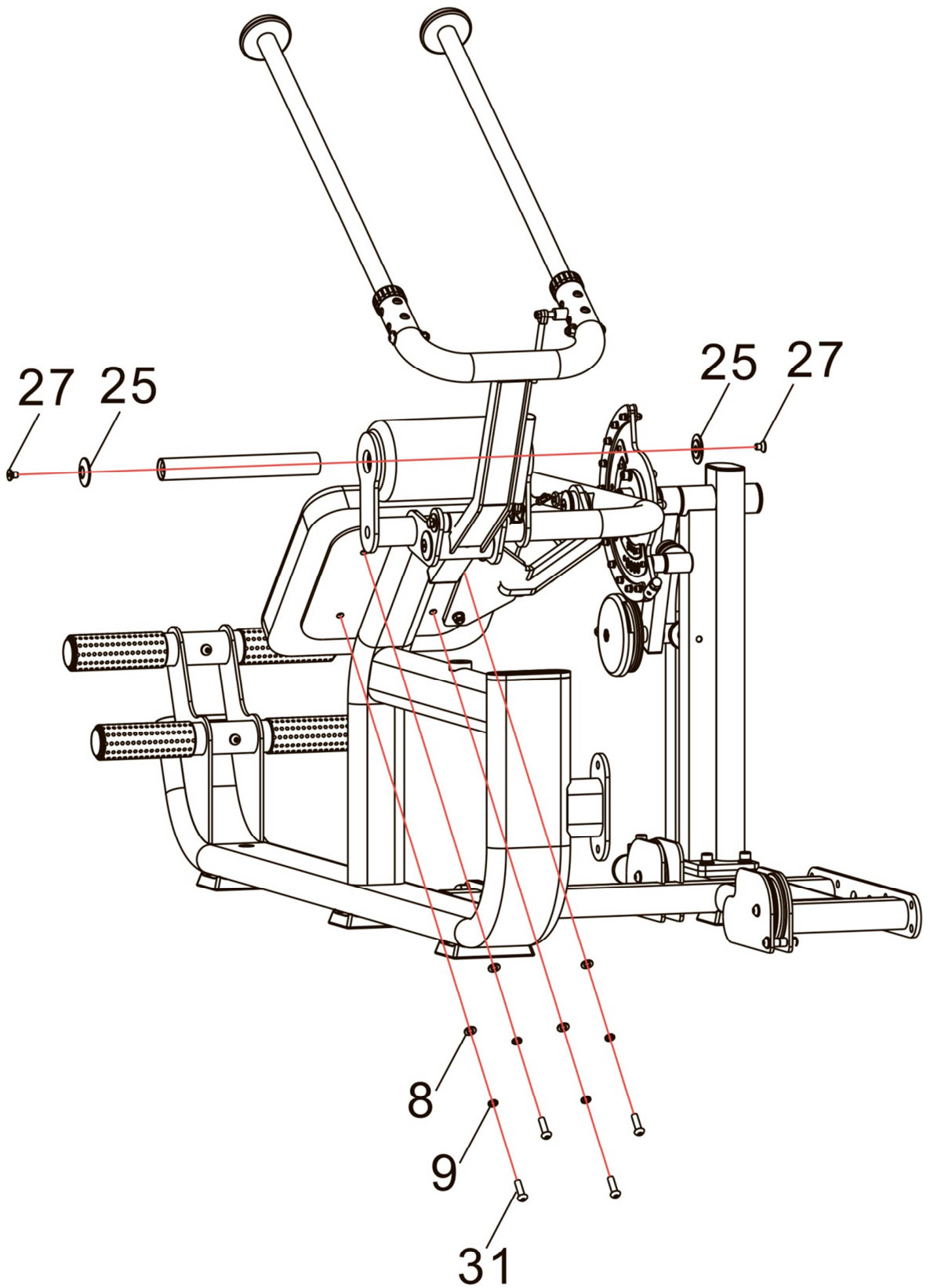

29  X1
M8 

30  X1
M8X30 



7





8  X4
M10 

9  X4
M10 



25  X2
 $\Phi 50$

27  X2
M10X15 

31  X4
M10X35 

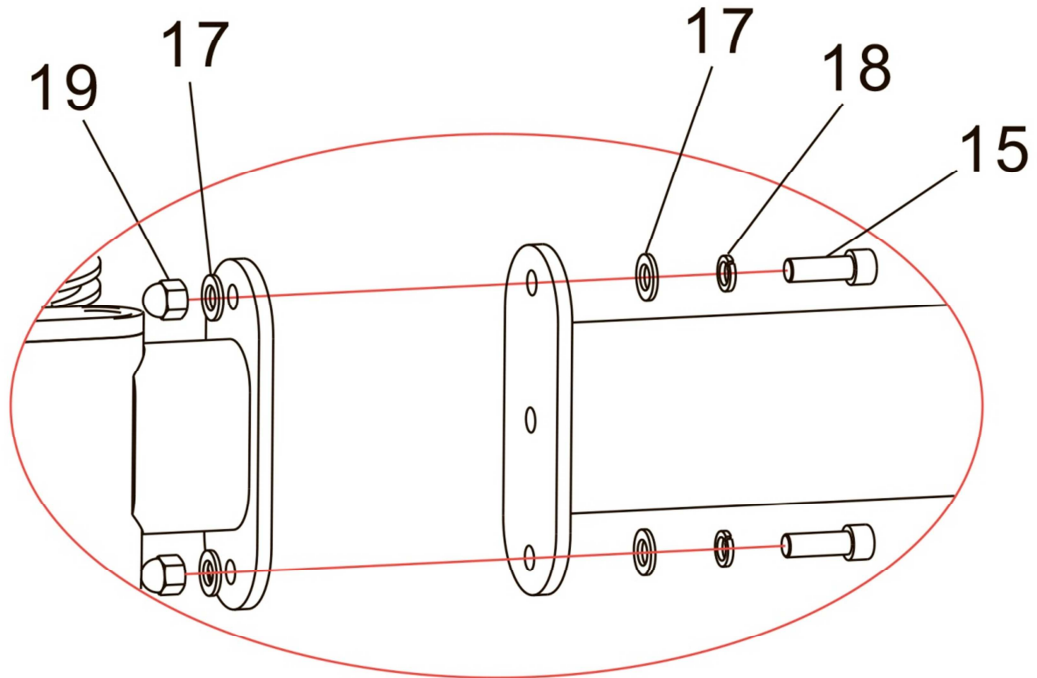
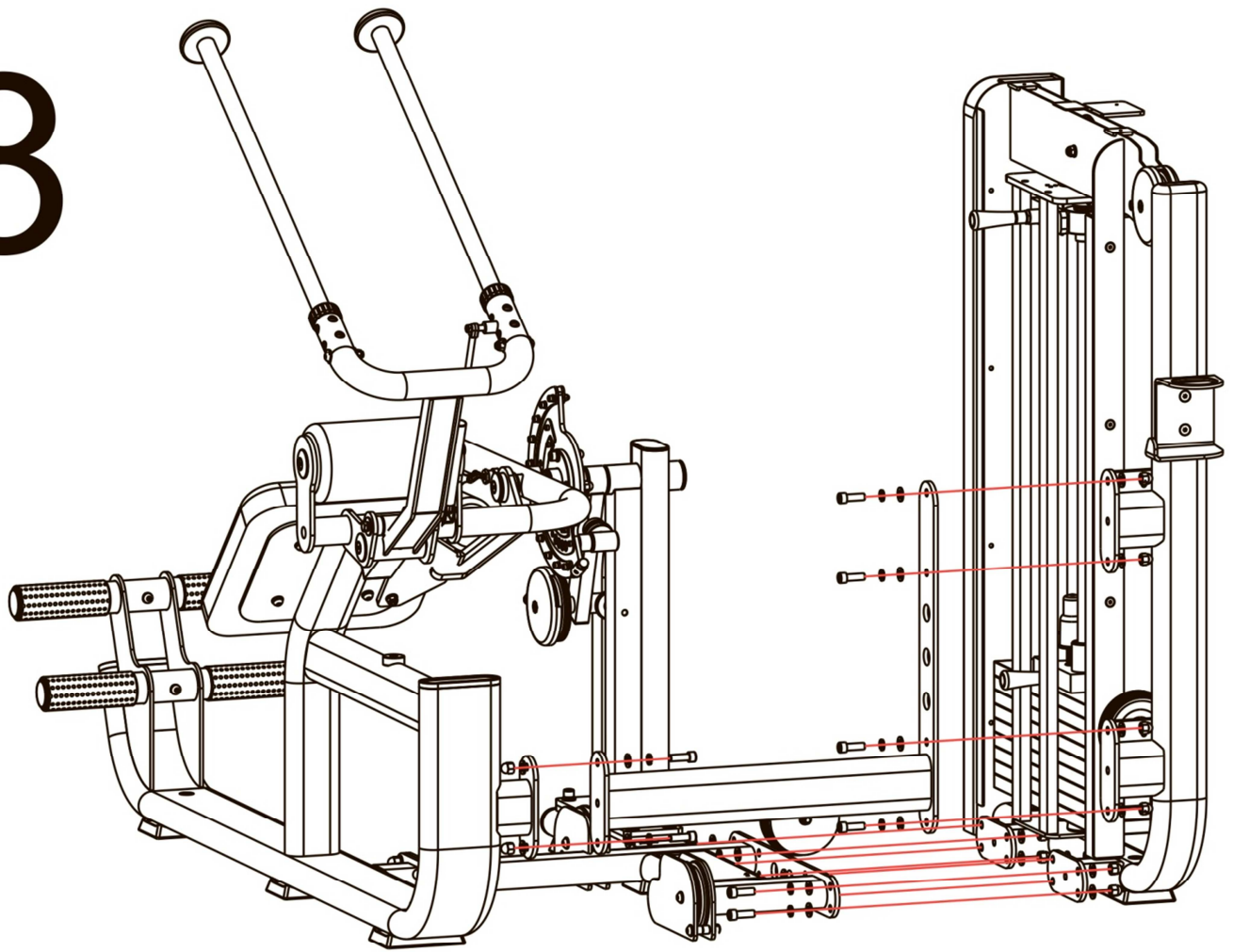
8

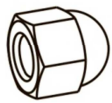

- | | | | | | | | | | | | |
|----|---|-----|-----|---|-----|----|--|-----|-----|---|-----|
| 15 |  | X14 | 17 |  | X28 | 18 |  | X14 | 19 |  | X14 |
| | M12X35 | | M12 | | M12 | | M12 | | M12 | | |

9

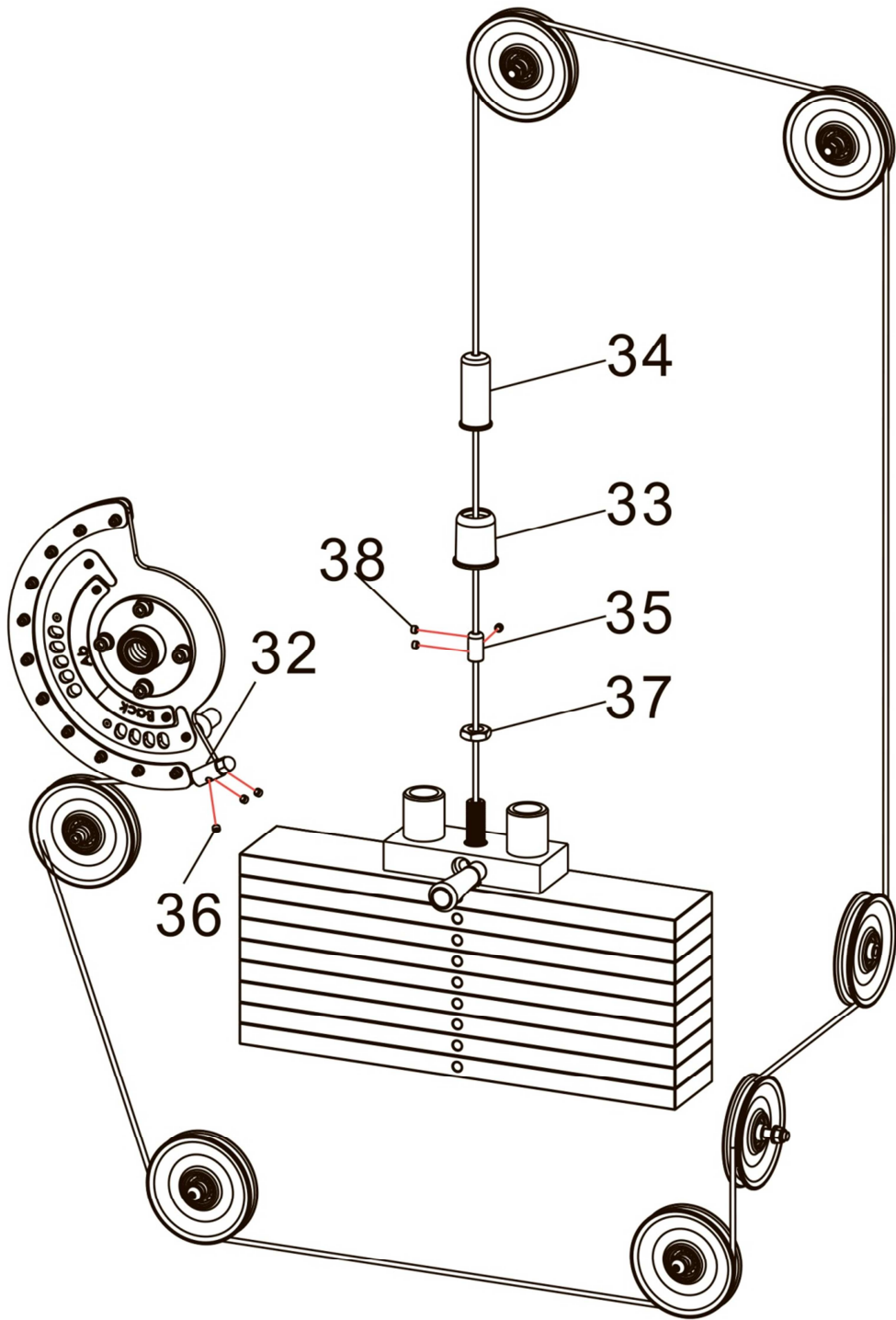

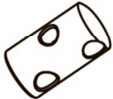
32  X1

$\Phi 20 \times \Phi 5 \times 35$

33  X1

$\Phi 50 \times \Phi 32 \times 58.4$

34  X1

$\Phi 36 \times \Phi 32 \times M20 \times 85$

35  X1

$\Phi 20 \times 35$ (侧面M8)

36  X3

M8X6 ●

37  X1



M20 ●



38  X3

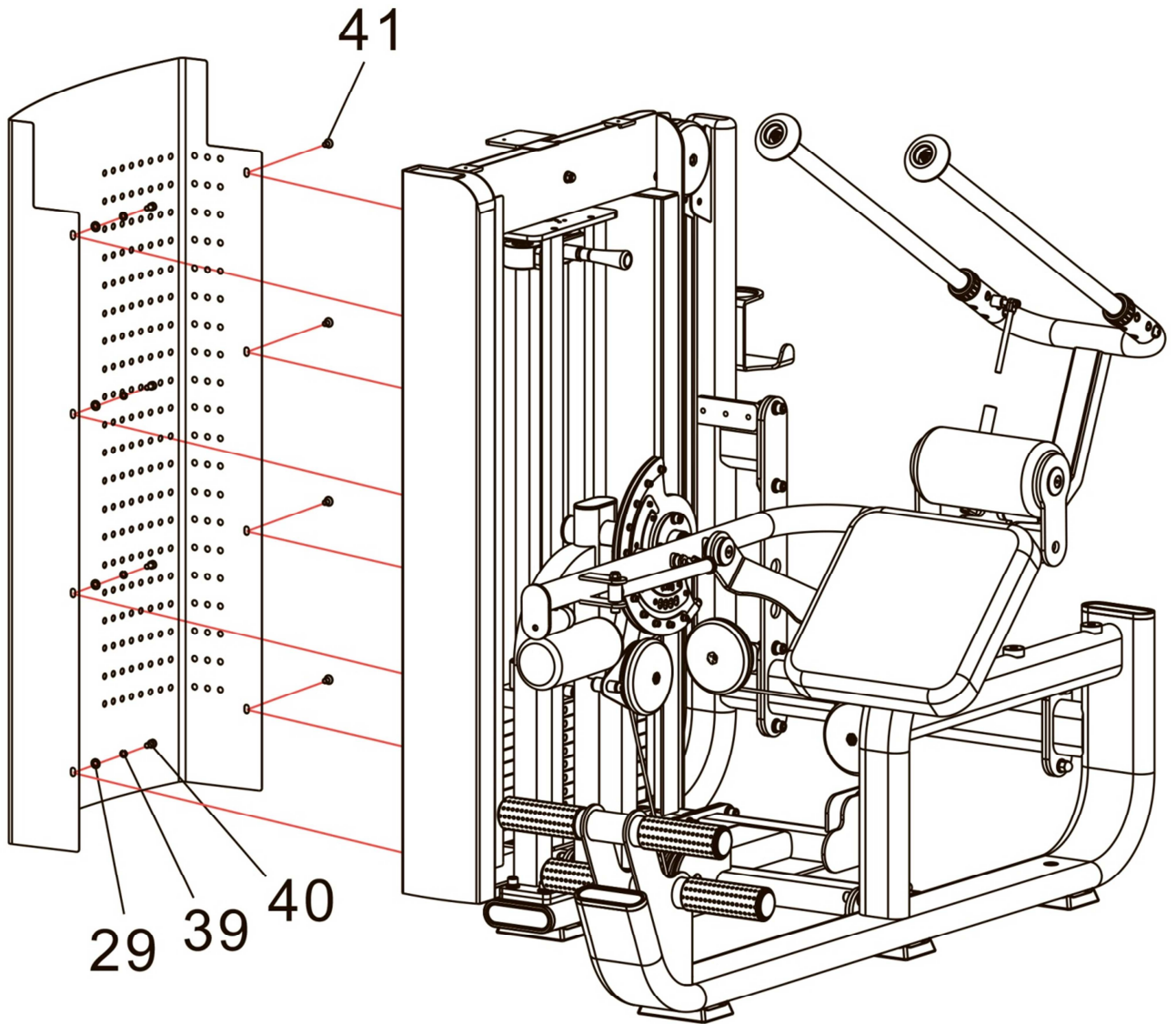

M8X8 ●

10

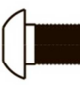

29  X4
M8 

39  X4
M8 

40  X4
M8X15 

41  X4
M8X15 

11

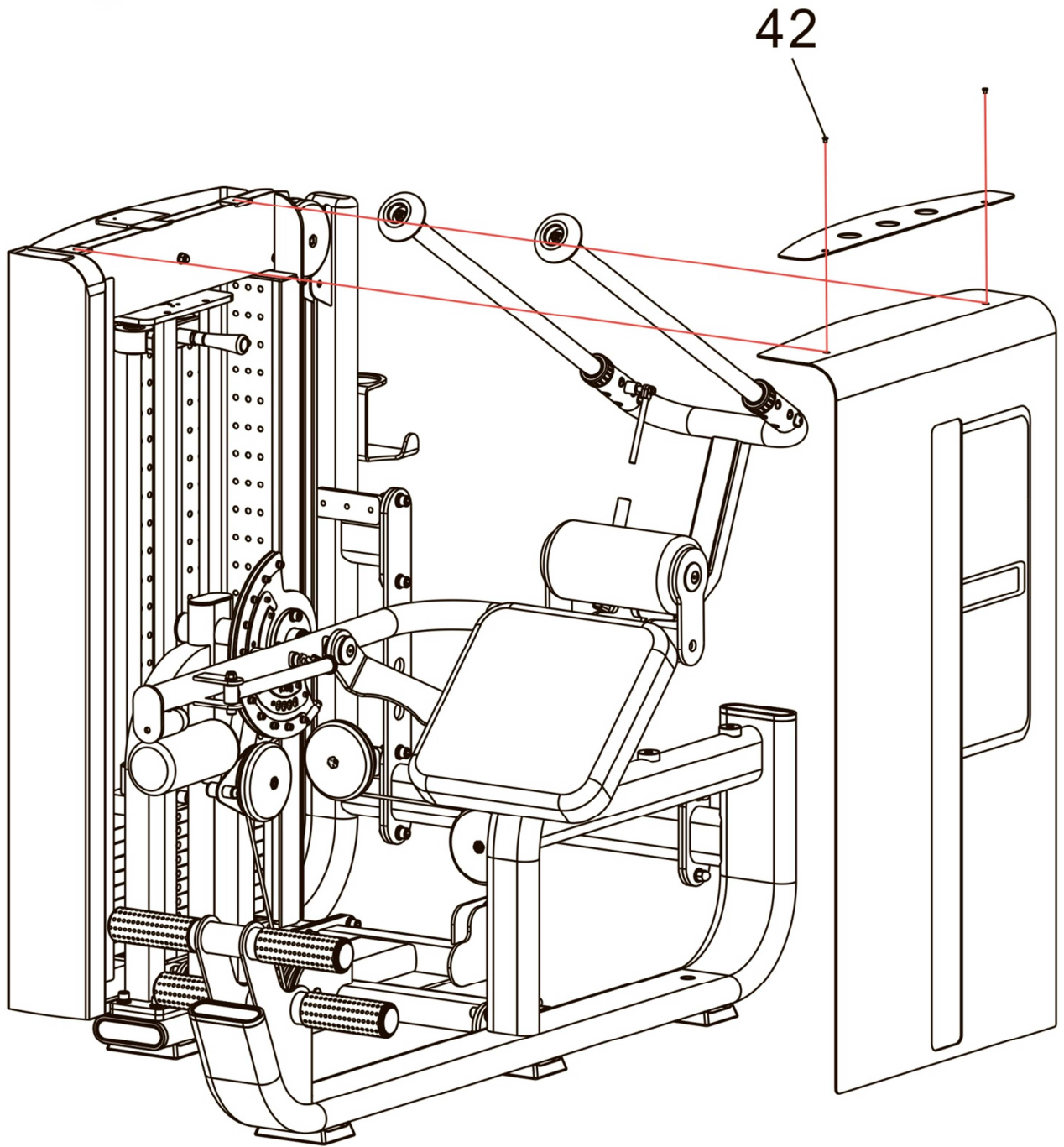

42  X2

M5X10 

1  X3
M6X12 ○

2  X2
M8X10 ●

3  X2
 $\Phi 62 \times \Phi 26 \times 25$

4  X2
M10X20 ○

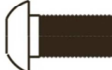
5  X2
M10X25 ○

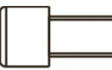
6  X1
M10X50 ○

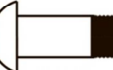
7  X1
M10X50 ○

8  X10
M10 ○

9  X8
M10 ○

10  X3
M10 ○

11  X1
 $\Phi 127$

12  X2
 $\Phi 22 \times \Phi 10.5 \times 13.5$

13  X1
(35+80)*25*2

14  X1
 $\Phi 127$

15  X18
M12X35 ○

16  X6
M12X30 ○

17  X42
M12 ○

18  X24
M12 ○

19  X18
M12 ○

20  X2
M10 ○

21  X2
M10X20 ○

22  X4
 $\Phi 50 * 2.5$

23  X4
 $\Phi 49 * \Phi 61 * 350$

24  X4
M10X30 ○

25  X6
 $\Phi 50$

26  X2
 $\Phi 31.5 * \Phi 26 * 3$

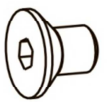
27  X4
M10X15 ○

28  X1
M8 ○

29  X5
M8 ○

30  X1
M8X30 ○

31  X4
M10X35 ○

32  X1
 $\Phi 20 * \Phi 5 * 35$

33  X1
 $\Phi 50 \times \Phi 32 \times 58.4$

34  X1
 $\Phi 36 \times \Phi 32 \times M20 \times 85$

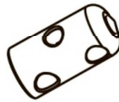
35  X1
 $\Phi 20 * 35$ (側面M8)

36  X3
M8X6 ●

37  X1
M20 ●

38  X3
M8X8 ●

39  X4
M8 ○

40  X4
M8X15 ○

41  X4
M8X15 ○

42  X2
M5X10 ○