

Инструкция

Силовая рама Impulse HSPR02

Полезные ссылки:

[Силовая рама Impulse HSPR02 - смотреть на сайте](#)

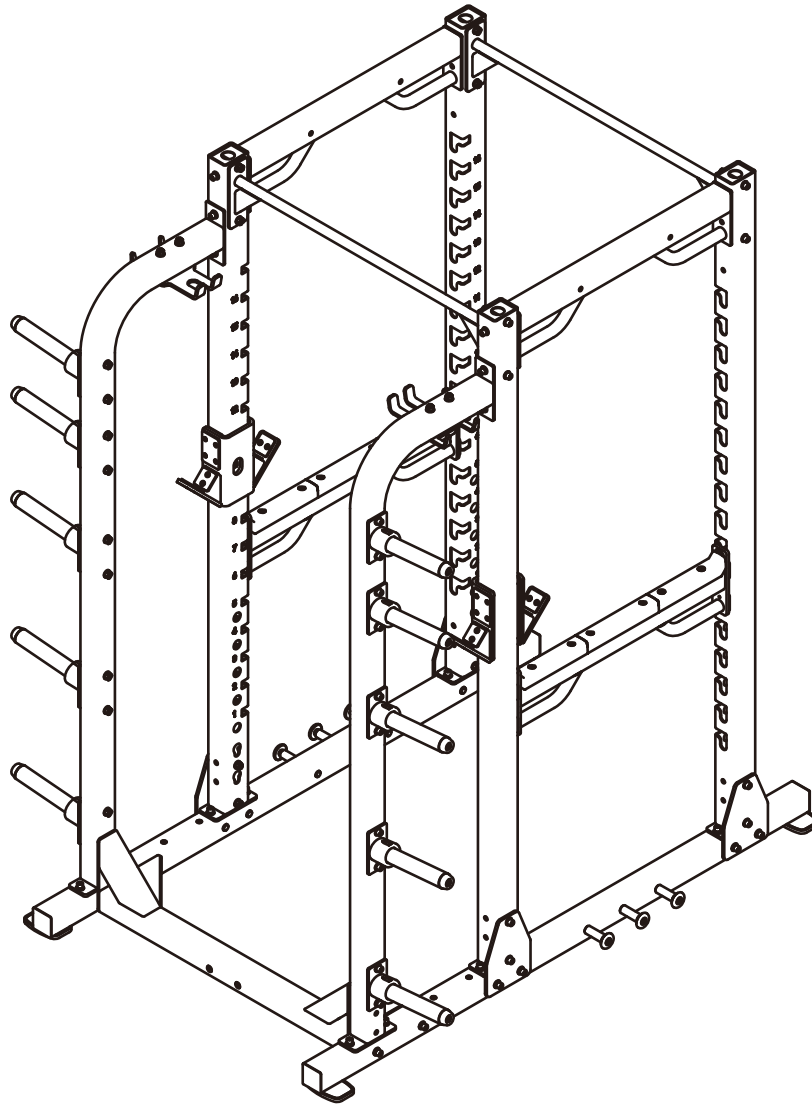

HSPR02

Full Rack

OWNER'S MANUAL

20V Rev B

CAUTION! Read all precautions and instructions in this manual before using this equipment.

Table Of Contents

CAUTION!

Read all precautions and instructions in this manual before using this equipment.

Important Safety Instructions-----	3
Instructions-----	5
Exploded View and Parts List-----	6
Measurement Guide-----	11
Assembly Instructions-----	12
Assembly-----	13
Adjust Instructions and Exercise Instructions-----	19
Maintenance Schedule-----	20
General Maintenance Information-----	21
Weight Training Tips-----	22

Important Safety Instructions

Before beginning any fitness program, you should obtain a complete physical examination from your physician. When using exercise equipment, basic precautions should always be taken, including the following:

1. Read all instructions before using the equipment.
These instructions are written to ensure your safety and to protect the unit.
2. Use the equipment only for its intended purpose as described in this guide.
Do not use accessory attachments that are not recommended by the manufacturer: such attachments might cause injuries.
3. The product should only be used on a level surface and is with 0.6 meters space around the product.
Do not use the equipment outdoors.
4. Do not allow children on or near the equipment. And children are not allowed to use this equipment.
Teenagers should use this equipment with adult supervision.
5. Do not overexert yourself or work to exhaustion.
Do not attempt to lift more weight than you can control safely.
If you feel any pain or abnormal symptoms, stop your workout immediately and consult your physician.
6. This equipment is not used as medical apparatus and instruments.
7. Never operate the unit when it has been dropped or damaged.
Never drop or insert anything into any opening in the equipment.
Always check the unit and its cables before each use. Make sure that all fasteners and cables are secure and in good working condition.
Frayed or worn cables can be dangerous and may cause injury. Periodically check these cables for any indication of wear.
Keep hands, limbs, loose clothing and long hair well out of the way of moving parts.
8. Be careful when getting on or off the equipment.
9. Wear proper exercise clothing and shoes for your workout, no loose clothing.

Important Safety Instructions

Personal Safety During Assembly

Read each step in the assembly instructions and follow the steps in sequence. Do not skip ahead. If you skip ahead, you may learn later that you have to disassemble components and that you may have damaged the equipment.

Assemble and operate the equipment on a solid, level surface. Locate the unit a few feet from walls or furniture to provide easy access. The equipment is designed for your enjoyment. By following these precautions and using common sense, you will have many safe and pleasurable hours of healthful exercise with the equipment.

Training Area and Free Area

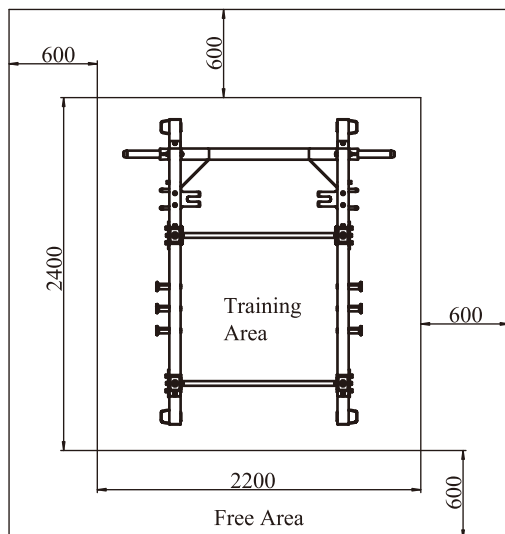

Specifications

Class: S

Maximum Wt. Capacity: 2*150kg/ 330lbs

Maximum User Weight: 150kg/ 330lbs

Product Dimension: 1842*2076*2476mm

Product Total Surface: 2200*2400mm

Product Total Mass:

Instructions

Before beginning assembly please take the time to read instructions thoroughly. Please use the various lists in this manual to make sure that all parts have been included in your shipment. When ordering, use part number and description from the lists. Use only our replacement part when servicing. Failure to do so will void your warranty and could result in personal injury.

The equipment is designed to provide the smoothest, most effective exercise motion possible. After assembly, you should check all functions to ensure correct operation. If you experience problems, first recheck the assembly instructions to locate any possible errors made during assembly. If you are unable to correct the problem, call your authorized dealer. Be sure to have your serial number and this manual when calling. When all parts have been accounted for, continue on.

Tools Required

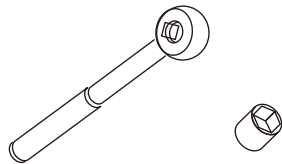

Ratchet Wrench and Socket

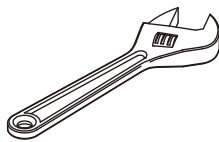

Adjustable Wrench

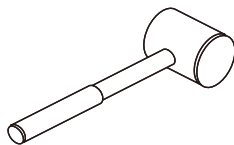

Rubber Mallet

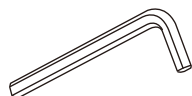

Hex Key Wrench Set

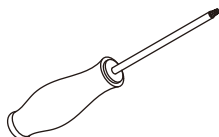

Phillips Screwdriver

Exploded View and Parts List

Overall

ItemNo.	Grade No.	Part No.	Description	QTY
1	1	HSPR0201ASSY	Left Base Frame ASSY	1
2	2	HSPR0202ASSY	Right Base Frame ASSY	1
3	3	HSPR011600	Weight Upright Frame	2
4	4	GB9512DHS2	Flat Washer $\Phi 13*\Phi 24*2.5$	114
5	5	GB9312DHS12	Spring Washer $\Phi 12$	34
6	6	GB70M12*100DHS20	Socket Head Cap Screw M12*100	30
7	7	NM12DHS2	Nylon Lock Nut M12	40
8	8	GB70M12*130DHS20	Socket Head Cap Screw M12*130	2
9	9	GB70M12*105DHS20	Socket Head Cap Screw M12*105	14
10	10	GB70M12*30DHS20	Socket Head Cap Screw M12*30	20
11	11	HSPR010500	Right Upright Frame	2
12	12	HSPR010600	Left Upright Frame	2
13	13	HSPR02B0300	Upside Connecting frame	2
14	14	HSPR010700	Straight tube pull-out handle	2
15	15	HSPR011500	Back Base Frame	1
16	16	HSPR012100	Fixing Plate	4
17	17	HSPR012200	Barbell bar hook	2
18	18	PL40014ASSY	Long Weight Plate Storage ASSY	10
19	19	HSPR0205ASSY	Safety Frame ASSY	2
20	20	HSPR0103ASSY	Left Safety Hook Frame ASSY	1
21	21	HSPR0104ASSY	Right Safety Hook Frame ASSY	1
22	22	GB70M12*125DHS20	Socket Head Cap Screw M12*125	8
23	31	NBS10DHS	Hex Key S=10	1
24	32	LW200BS	Wrench $\Phi 6*117$	1

Exploded View and Parts List

Overall

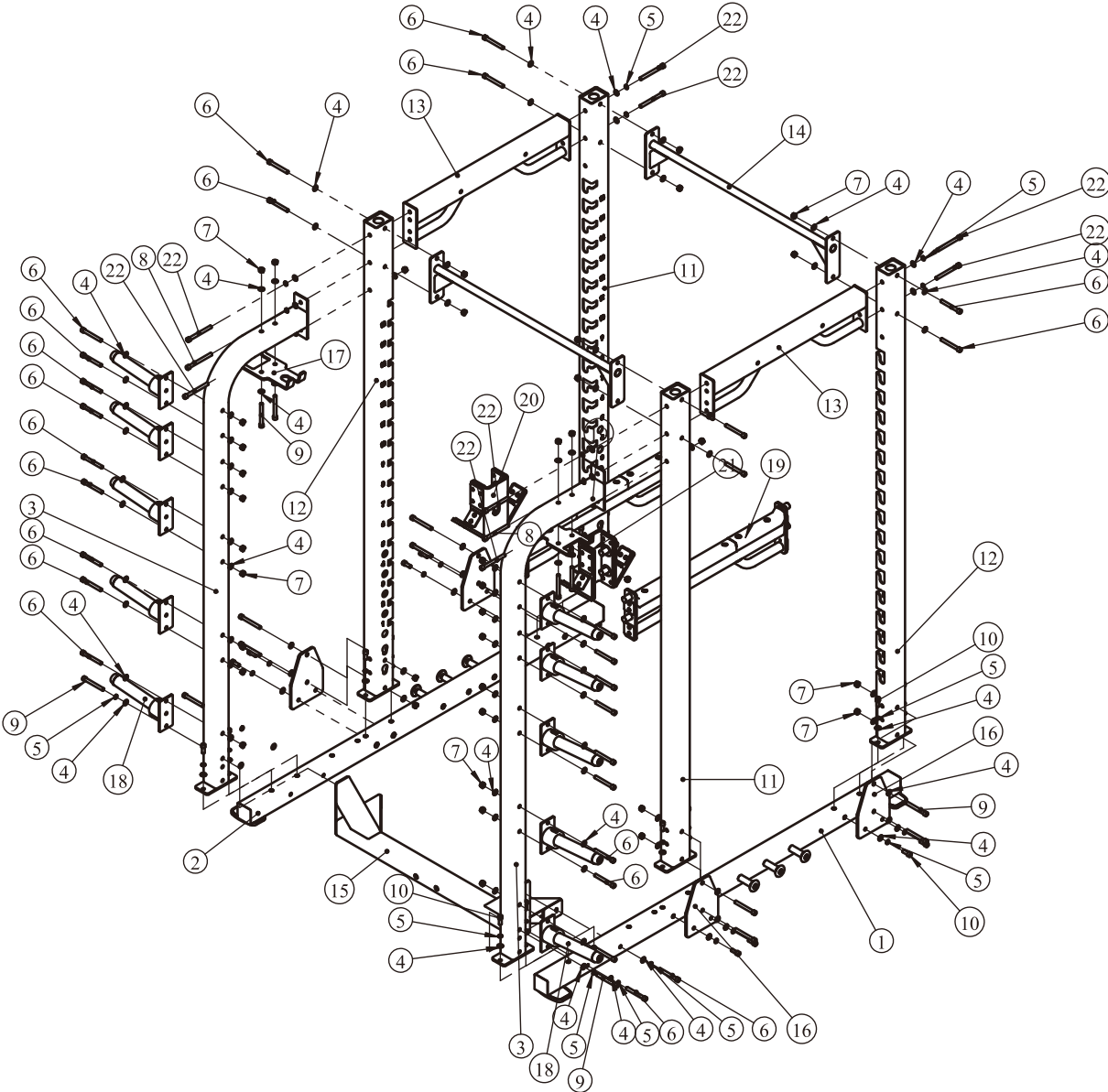

Exploded View and Parts List

Left Base Frame ASSY

Right Base Frame ASSY

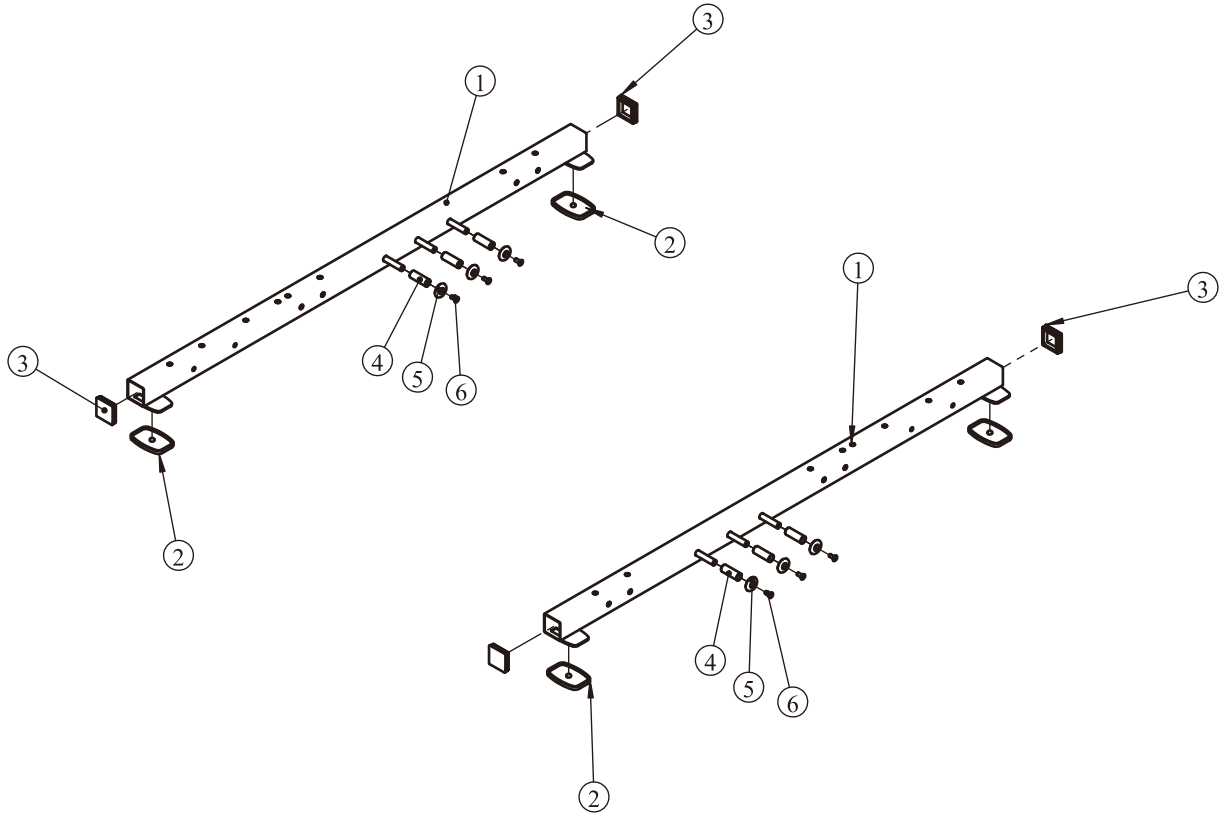

ItemNo.	Grade No.	Part No.	Description	QTY
1	1.1	HSPR020100ASSY	Left Base Frame First ASSY	1
2	1.2	IF81162000	Foot Plate	2
3	1.3	PBF30013	Plug □75	2
4	1.4	HSPR013100	Nylon roller	3
5	1.5	IN-S51102100	Aluminum Cap	3
6	1.6	CNLM10*25DS20NL	Flat Head Cap Screw 10*25	3

ItemNo.	Grade No.	Part No.	Description	QTY
1	2.1	HSPR010200ASSY	Right Base Frame First ASSY	1
2	2.2	IF81162000	Foot Plate	2
3	2.3	PBF30013	Plug □75	2
4	2.4	HSPR013100	Nylon roller	3
5	2.5	IN-S51102100	Aluminum Cap	3
6	2.6	CNLM10*25DS20NL	Flat Head Cap Screw 10*25	3

Exploded View and Parts List

Long Weight Plate Storage ASSY

Safety Frame ASSY

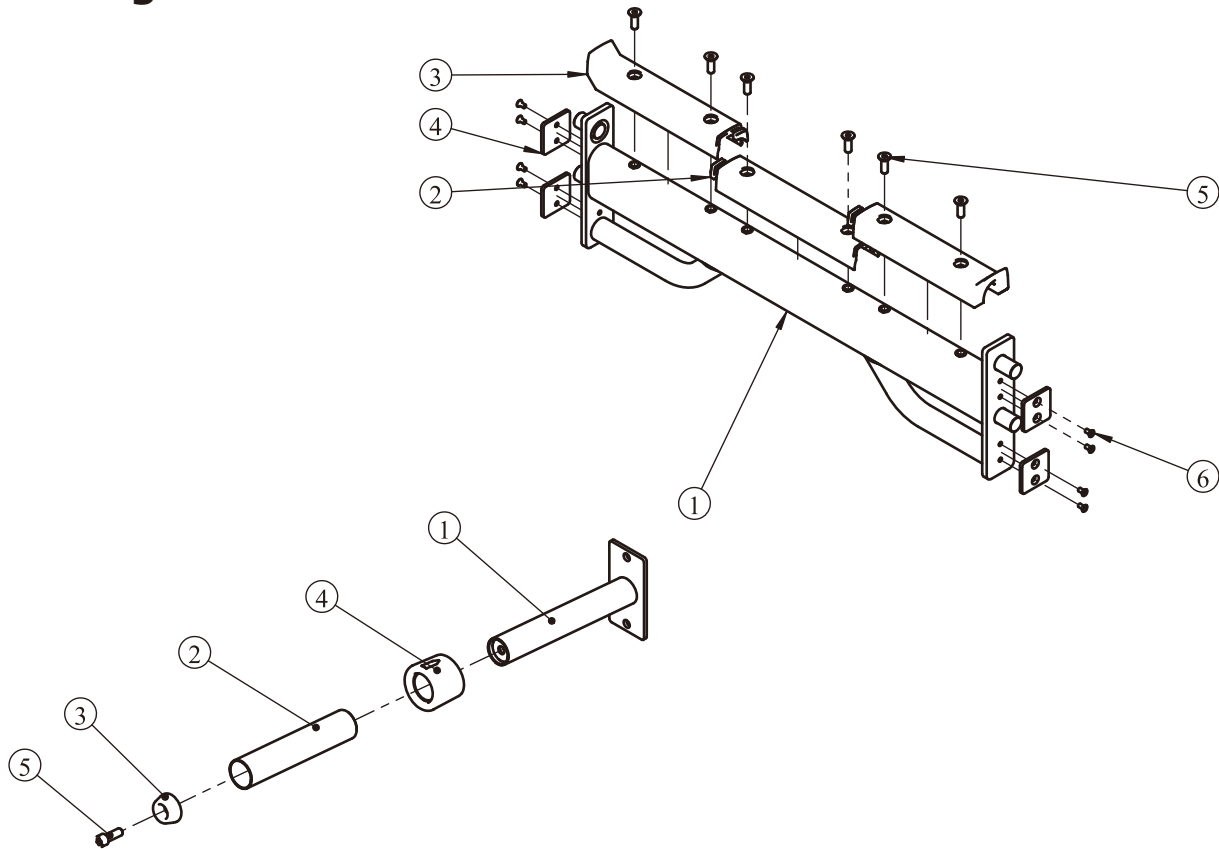

ItemNo.	Grade No.	Part No.	Description	QTY
1	18.1	PL4001400	Long Weight Plate Storage	1
2	18.2	PL0702800	Barbell casing $\Phi 48*\Phi 45*233$	1
3	18.3	PL0702300	Weight Horn Plastic Cap	1
4	18.4	PL4003200	Weight Horn Rubber Donut	1
5	18.5	GB70M12*35N19	Socket Head Cap Screw M12*35	1

ItemNo.	Grade No.	Part No.	Description	QTY
1	19.1	HSPR020500ASSY	Safety Frame First ASSY	1
2	19.2	PL4002800	Long Safty Bumper	1
3	19.3	PL3502900	Short Safty Bumper	2
4	19.4	DBR06102500	Plastic Plate2	4
5	19.5	CNLM10*30DHS18NL	Flat Head Cap Screw M10*30	6
6	19.6	GB819M6*12DHS2	Flat Head Cap Screw M6*12	8

Exploded View and Parts List

Left Safety Hook Frame ASSY

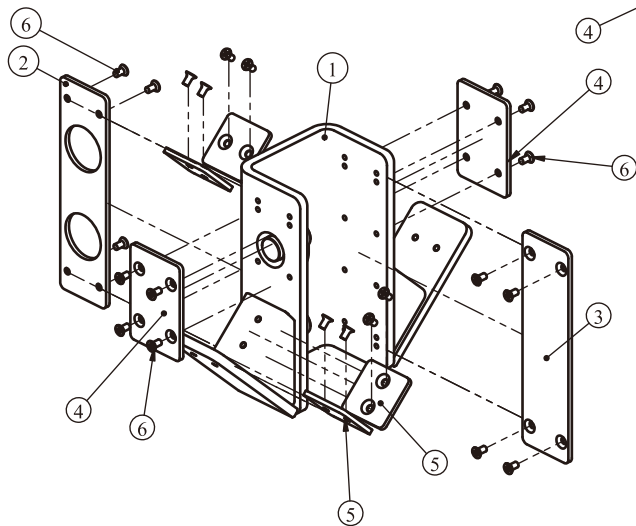

Right Safety Hook Frame ASSY

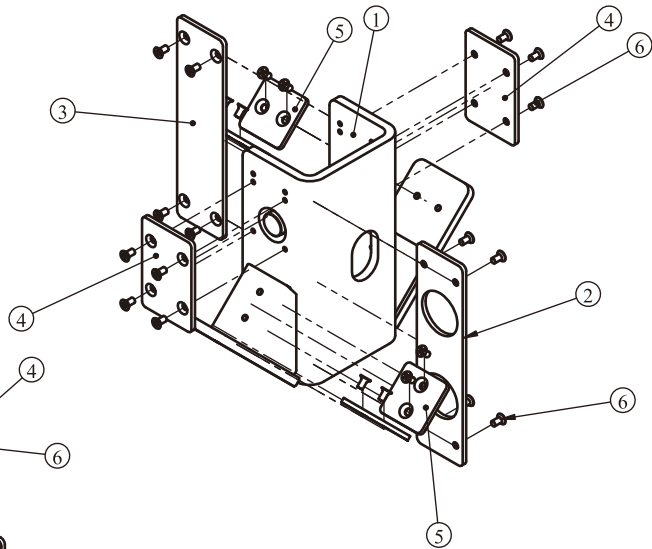

ItemNo.	Grade No.	Part No.	Description	QTY
1	20.1	HSPR010300	Left Safety Hook Frame	1
2	20.2	CHFPR1900	Plastic Plate 1	1
3	20.3	SE50011200	Plastic Plate 2	1
4	20.4	HSPR013200	Plastic Plate	2
5	20.5	DBR06102500	Plastic Plate2	4
6	20.6	GB819M6*12DHS2	Flat Head Cap Screw M6*12	24

ItemNo.	Grade No.	Part No.	Description	QTY
1	21.1	HSPR010400	Right Safety Hook Frame	1
2	21.2	CHFPR1900	Plastic Plate 1	1
3	21.3	SE50011200	Plastic Plate 2	1
4	21.4	HSPR013200	Plastic Plate	2
5	21.5	DBR06102500	Plastic Plate2	4
6	21.6	GB819M6*12DHS2	Flat Head Cap Screw M6*12	24

Measurement Guide

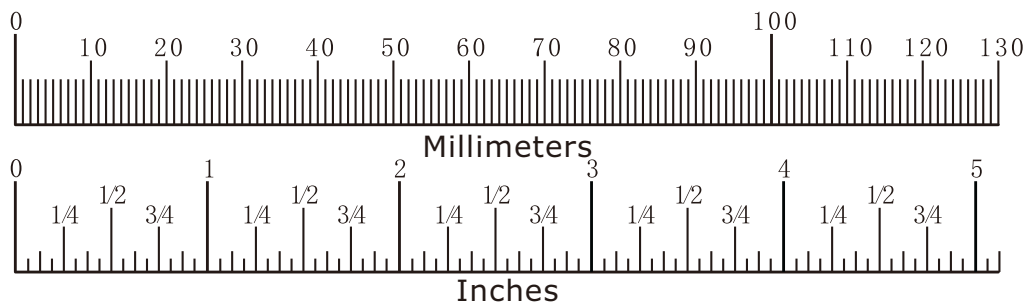
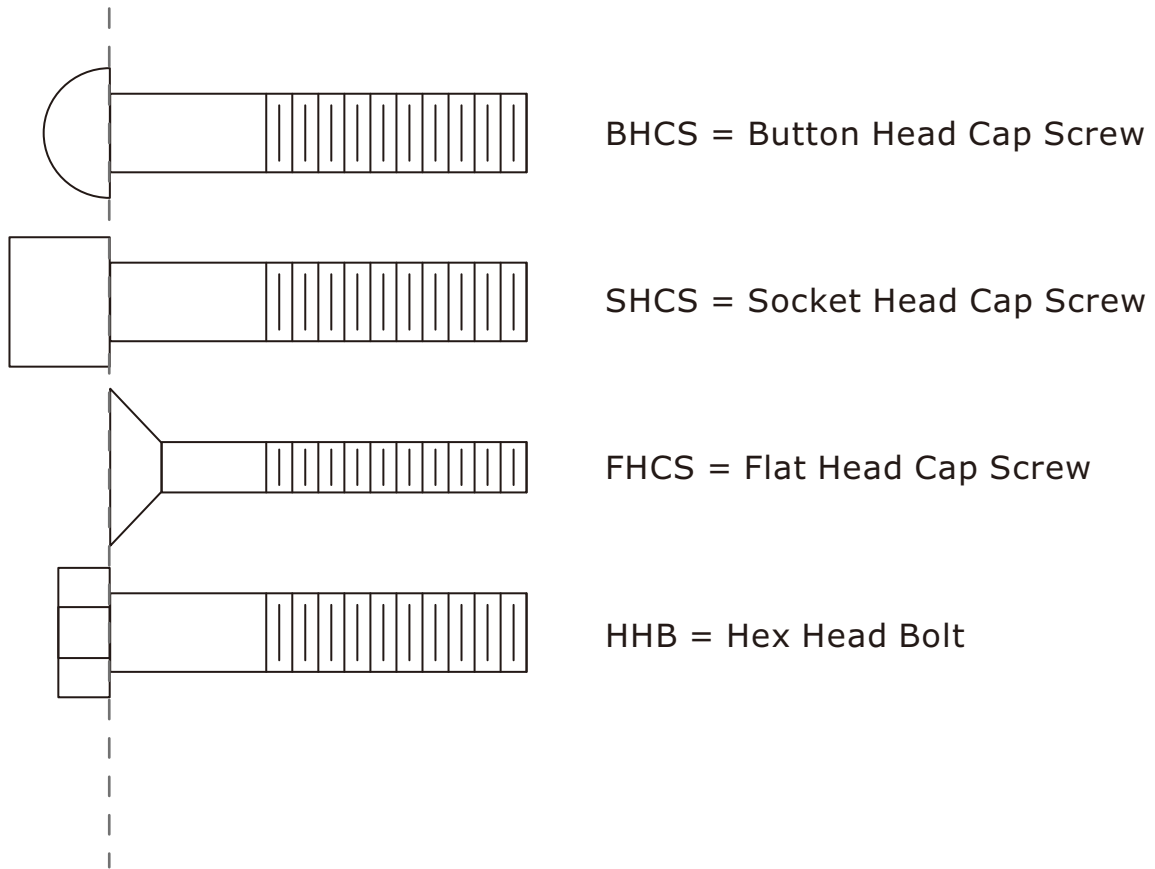

Diameter of bolt (mm/inch)	M6(1/4")	M8(5/16")	M10(3/8")	M12(1/2")	M16(5/8")
Tightening torque (N.m)	9~12	22~30	45~59	78~104	193~257
Operational methods for adult men	The strength of the wrist	The strength of the wrist and forearm	The strength of the entire arm	The strength of the arm and upper body	with all strength

Assembly Instructions

Assembly of the equipment takes professional installers about 2 hours. If this is the first time you have assembled this type of equipment, plan to spend more time. It is strongly recommended to assemble the equipment by professional installers. You may find it quicker, safer, easier to assemble this equipment with the help of a friend, as some of components may be large, heavy or awkward to handle alone. It is important that you assemble your product in a clean, clear, uncluttered area. This will enable you to move around the product while you are fitting components and reduce the possibility of injury during assembly.

NOTE

As with any assembled part, proper alignment and adjustment is critical. While tightening the fasteners, be sure to leave room for adjustments. Do not fully tighten the fasteners until instructed to do so. Be careful to assemble the components in the sequence presented in this guide.

Assembly

STEP 1

1. Attach the Left Base Frame ASSY (#1) to the Back Base Frame (#15) using:
 - two M12*100 SHCS (#6)
 - two $\Phi 13*\Phi 24*2.5$ Flat Washer (#4)
 - two $\Phi 12$ Spring Washer (#5)
2. Attach the Right Base Frame ASSY (#2) to the Back Base Frame (#15) using:
 - two M12*100 SHCS (#6)
 - two $\Phi 13*\Phi 24*2.5$ Flat Washer (#4)
 - two $\Phi 12$ Spring Washer (#5)

Note: Wrench Tighten Bolts and Nylon Lock Nuts.

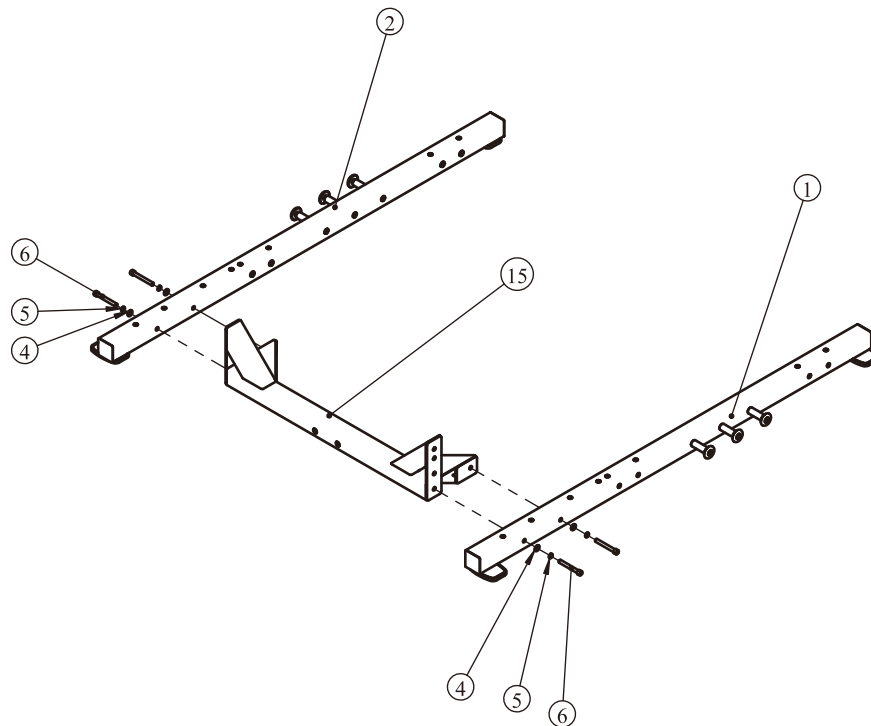

Assembly

STEP 2

1. Attach two Left Upright Frame (#12) and two Right Upright Frame (#11) to the Left Base Frame ASSY (#1) and the Right Base Frame ASSY (#2) using:
 - eight M12*30 SHCS (#10)
 - eight $\Phi 13*\Phi 24*2.5$ Flat Washer (#4)
 - eight $\Phi 12$ Spring Washer (#5)
2. Attach Two Weight Upright Frame (#3) to the Left Base Frame ASSY (#1) and the Right Base Frame ASSY (#2) using:
 - four M12*30 SHCS (#10)
 - four $\Phi 13*\Phi 24*2.5$ Flat Washer (#4)
 - four $\Phi 12$ Spring Washer (#5)
3. Attach two Upper side connecting frame (#13) to two Left Upright Frame (#12) and two Right Upright Frame (#11), Attach Two Weight Upright Frame (#3) to the Left Upright Frame (#12) and the Right Upright Frame (#11) using:
 - two M12*130 SHCS (#8)
 - ten $\Phi 13*\Phi 24*2.5$ Flat Washer (#4)
 - eight $\Phi 12$ Spring Washer (#5)
 - two M12 Nylon Lock Nut (#7)
 - eight M12*125 SHCS (#22)
4. Attach two Straight tube pull-out handle (#14) to two Left Upright Frame (#12) and two Right Upright Frame (#11) using:
 - eight M12*100 SHCS (#6)
 - eight M12 Nylon Lock Nut (#7)
 - sixteen $\Phi 13*\Phi 24*2.5$ Flat Washer (#4)

Note: Wrench Tighten Bolts and Nylon Lock Nuts.

Assembly

STEP 2

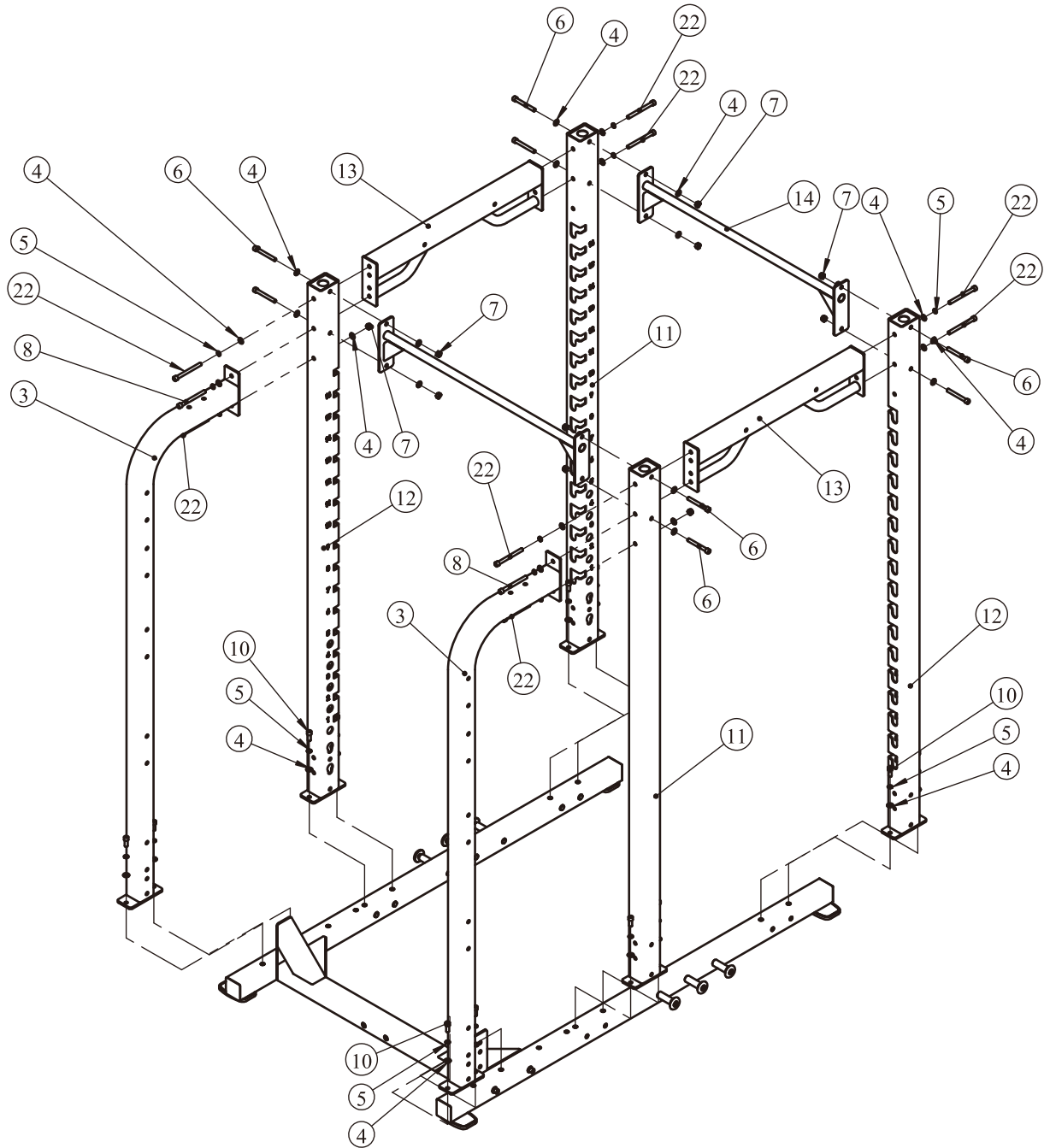

Assembly

STEP 3

1. Attach Four Fixing Plate (#16) to the Left Upright Frame (#12) and the Left Base Frame ASSY (#1), the Right Upright Frame (#11) and the Right Base Frame ASSY (#2), the Left Upright Frame (#12) and the Right Base Frame ASSY (#2), the Right Upright Frame (#11) and the Left Base Frame ASSY (#1) using:
 - eight M12*105 SHCS (#9)
 - eight M12*30 SHCS (#10)
 - twenty four $\Phi 13*\Phi 24*2.5$ Flat Washer (#4)
 - eight $\Phi 12$ Spring Washer (#5)
 - eight M12 Nylon Lock Nut (#7)
2. Attach ten WT Bar ASSY (#18) to two Weight Upright Frame (#3) using:
 - two M12*105 SHCS (#9)
 - eighteen M12*100 SHCS (#6)
 - two $\Phi 12$ Spring Washer (#5)
 - thirty-eight $\Phi 13*\Phi 24*2.5$ Flat Washer (#4)
 - eighteen M12 Nylon Lock Nut (#7)
3. Attach two Barbell bar hook (#17) to two Weight Upright Frame (#3) using:
 - four M12*105 SHCS (#9)
 - eight $\Phi 13*\Phi 24*2.5$ Flat Washer (#4)
 - four M12 Nylon Lock Nut (#7)

Note: Wrench Tighten Bolts and Nylon Lock Nuts.

Assembly

STEP 3

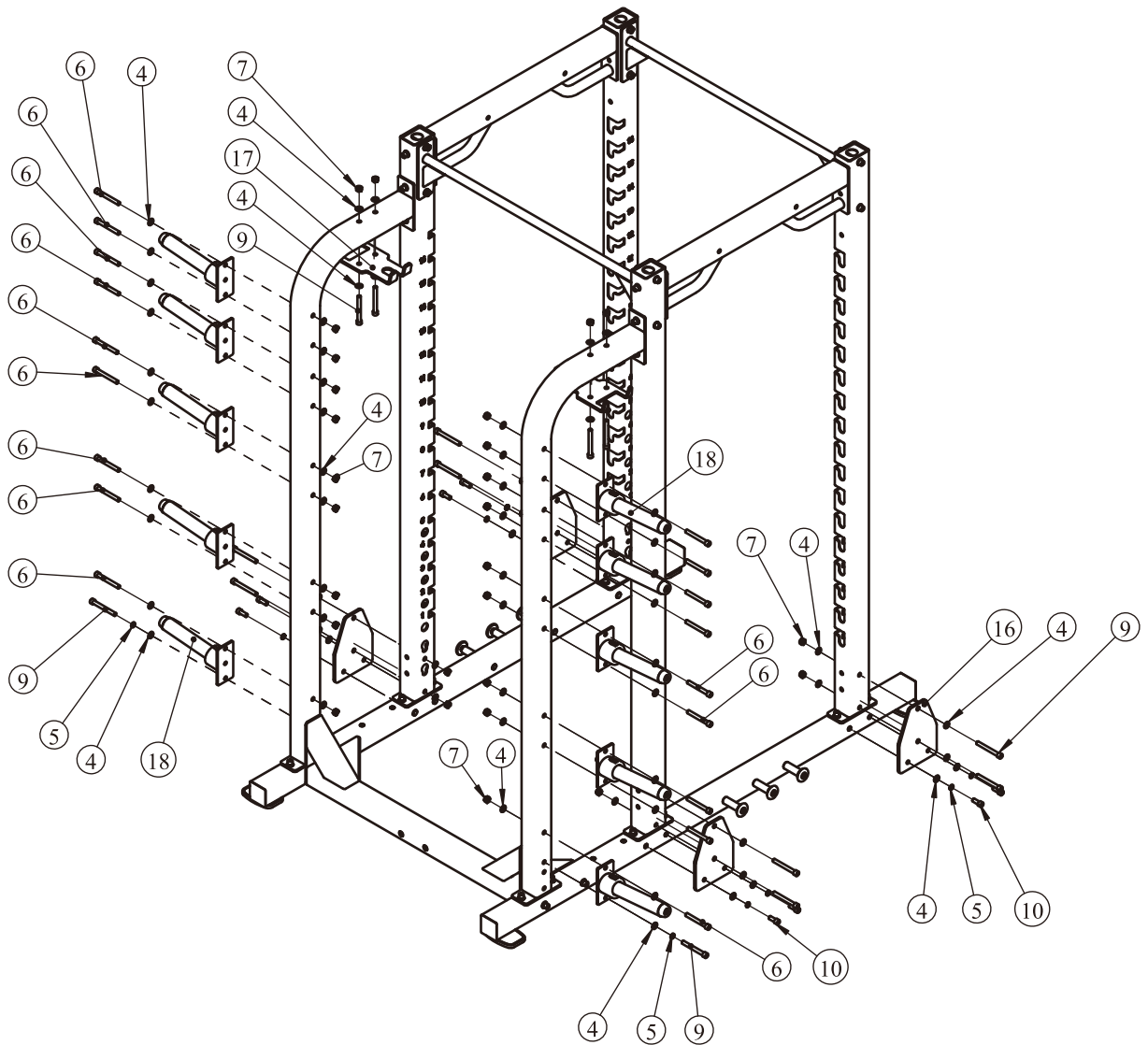

Assembly

STEP 4

1. Attach the Left Safety Hook Frame ASSY (#20) and Safety Frame ASSY (#19) to the Left Upright Frame (#12).
2. Attach the Right Safety Hook Frame ASSY (#21) and Right Safety Frame ASSY (#19) to the Right Upright Frame (#11).

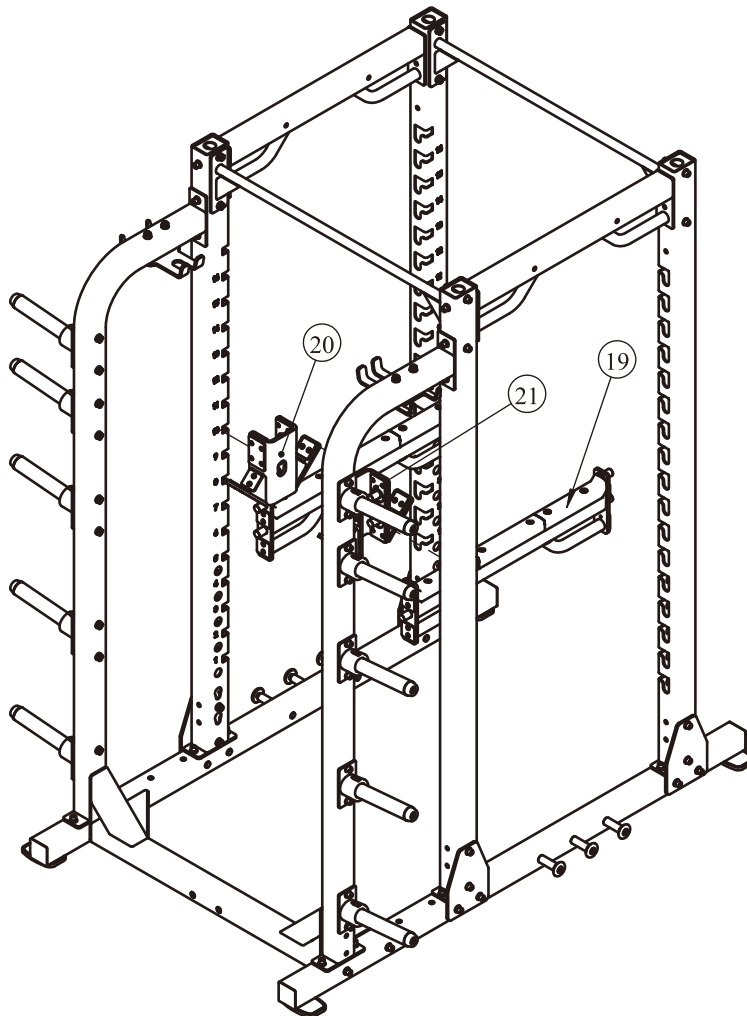

Adjust Instructions and Exercise Instructions

Weightlifting

1. Adjust Safety Frame ASSY and Safety Hook Frame ASSY to the desired position.
2. Select an appropriate weight then do weightlifting exercise with Barbell.
3. The total weight of one side of Barbell can not be greater than 150kg.
4. This equipment does not contains Barbell and Weight Plate.

Safety Frame ASSY & Safety Hook Frame ASSY Adjustment

1. Adjust Safety Frame ASSY & Safety Hook Frame ASSY to the desired position.
2. Make sure Safety Frame ASSY are below Safety Hook Frame ASSY.
3. Make sure both Safety Hook Frame ASSY are the same height.
4. Make sure both Safety Frame ASSY are the same height.

Exercise Instructions

Chin-up

Do Chin-up with LatBar

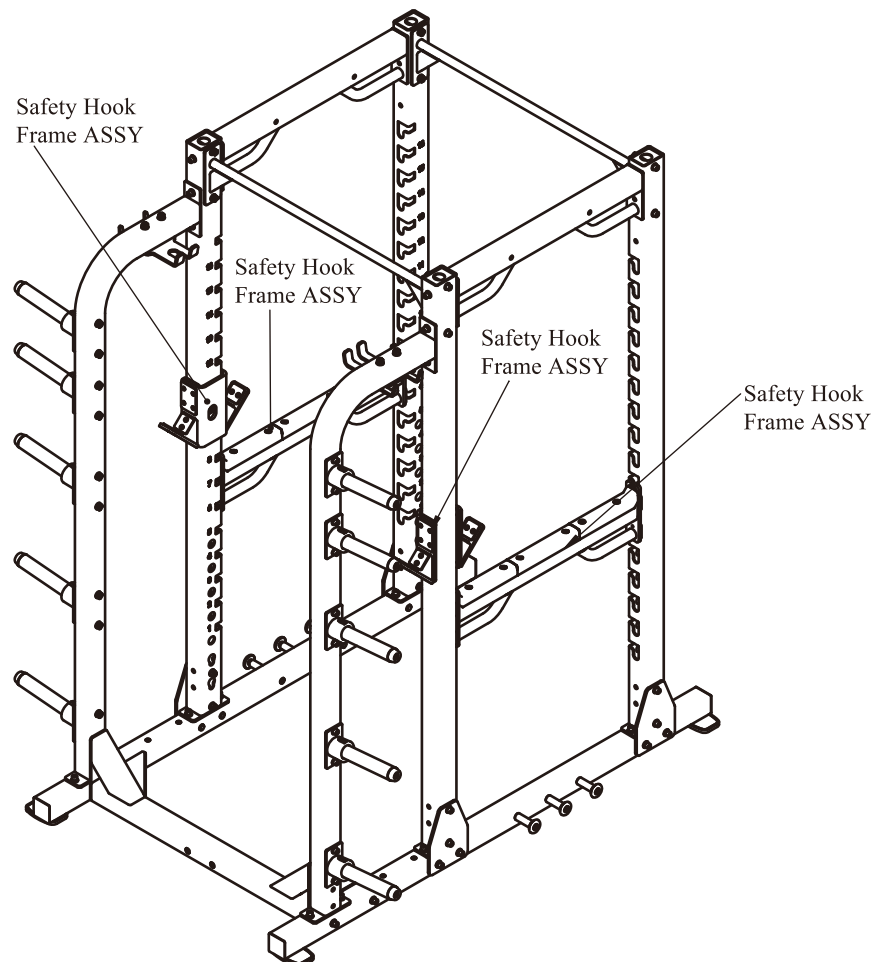

Maintenance Schedule

ROUTINE	COMMERCIAL MAINTENANCE	HOME MAINTENANCE	LATEST DATE ENTRY					
Inspect; Links, Pull Pins, Snap Locks, Swivels, Weight Stack Pins	DAILY	WEEKLY						
Clean; Upholstery	DAILY	WEEKLY						
Inspect; Cables or Belts and their tension	DAILY	WEEKLY						
Inspect; Accessory Bars, and Handles	WEEKLY	3 MONTHS						
Inspect; All Decals	WEEKLY	3 MONTHS						
Inspect; All Nuts and Bolts, Tighten if needed	WEEKLY	3 MONTHS						
Inspect; Anti-Skid Surface	WEEKLY	3 MONTHS						
Clean & Lubricate; Guide Rods with a Teflon (PTFE) based lubricant (Superlube)	MONTHLY	3 MONTHS						
Lubricate; Seat Sleeves, Turcite Bushings, Linear Bearing	MONTHLY	3 MONTHS						
Clean and Wax; All Glossy Finishes	6 MONTHS	YEARLY						
Repack with Grease; Linear Bearings	6 MONTHS	YEARLY						
Replace; Cables, Belts and Connecting Parts	YEARLY	3 YEARS						

Your equipment comes with a commercial maintenance decal. For personal, in home use, please follow the home maintenance schedule listed above.

General Maintenance Information

Links, Pull-Pins, Snap Hooks, Swivels, Weight Stack Pins:

- * Check all pieces for signs of visible wear or damage.
- * Check springs in snap hooks and pull-pins for proper tension and alignment.
- * If the spring sticks or has lost its rigidity, replace it immediately.

Upholstery:

- * To ensure prolonged upholstery life and proper hygiene, all upholstered pads should be wiped down with a damp cloth after every workout.
- * Periodically take the time to use a mild soap or an approved vinyl upholstery cleaner to deter the onset of cracking or drying. Avoid using any abrasive cleaners or cleaners not intended for use on vinyl.
- * Replace ripped or worn upholstery immediately.
- * Keep sharp or pointed objects clear of all upholstery.

Decals:

- * Inspect and familiarize yourself with any safety warnings or other user information posted on each decal.

Nuts and Bolts:

- * Inspect all nuts and bolts for any loosening and tighten if needed.
- * Go through a re-tightening sequence periodically to ensure that all hardware is tensioned proper.

Anti-Skid Surfaces:

- * These surfaces are designed to supply secure footing and need to be replaced if they appear worn or become slippery.

Belts and Cables:

- * We use only high quality belt, and mil-spec cables.
- * Visually inspect the belts and cables for fraying, cracking, peeling or discoloration.
- * While the machine is not in use, carefully run your fingers along the belt or cable to feel for thinning or bulging areas.
- * Replace belts and cables immediately at the first signs of damage or wear. Do not use equipment until belts or cables have been replaced.

Belt and Cable Tension:

- * Referring to the Owners Manual, when belts or cables are used check all bolt attachments to be sure they are properly attached.
- * Check slack in cables and re-adjust cable tension if needed.

Seat Sleeves, Guide Rods:

- * Wipe down adjusting tubes with a dust free rag before applying lubricant.
- * Lubricate seat sleeves and Guide Rods with a Silicon or Teflon based lubricant spray.

Linear Bearings:

- * Referring to the Owners Manual carefully disassemble the bearing from its housing and place a finger full of light grease (lithium, super lube, etc.) into the inside of the bearing. Using your finger, press the grease into the ball-bearings and their tracks. Repeat until the ball-bearing tracks are full of grease. Insert the shaft back into the bearing and wipe off excess grease.

PLEASE KEEP THIS FOR YOUR RECORDS

Weight Training Tips

Use this manual to guide you through the basic exercises you can perform on your equipment. To gain maximum results and avoid possible injury, consult a fitness professional to develop your complete exercise program.

Always consult your physician before starting any exercise program.

To be successful in your exercise program, it is important to develop an understanding of the basic principles of strength training. Now that you have your equipment, it is only natural that you want to get started immediately. First, determine a set of realistic goals and objectives for yourself. By deciding on an exercise plan that is right for you prior to starting, you will contribute significantly to your success.

Warm up properly before engaging in weight resistance training. Stretching, yoga, jogging, calisthenics or other cardiovascular exercise can help prepare your body for the heavier workload of lifting weights.

Learn how to perform the exercise correctly before using heavy weight. Correct form is important to avoid injury and to ensure that you work the proper muscle groups.

Know your limitations. If you are new to weight training or are embarking on an exercise regimen after a long layoff, start slowly and build foundational strength over a longer period of time.

Pay attention to your breathing. Exhale when you exert is a general rule of thumb. Never hold your breath.

