

Инструкция

Силовой комплекс BodySolid PHG1000X

Полезные ссылки:

[Силовой комплекс BodySolid PHG1000X - смотреть на сайте](#)

[Силовой комплекс BodySolid PHG1000X - читать отзывы](#)

PHG-1000

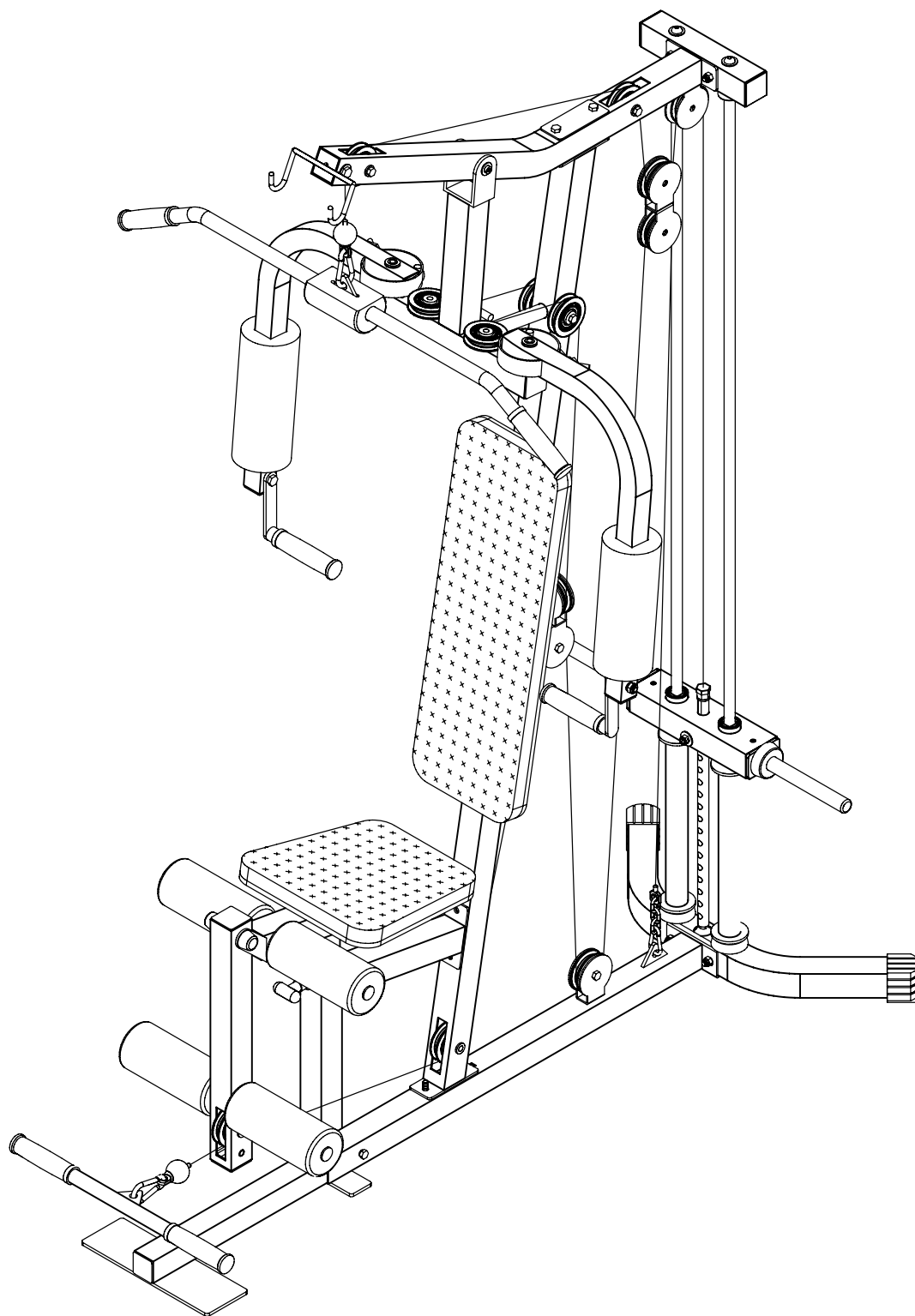

Архангельск (8182)63-90-72	Ижевск (3412)26-03-58	Магнитогорск (3519)55-03-13	Пермь (342)205-81-47	Сургут (3462)77-98-35
Астана (7172)727-132	Иркутск (395)279-98-46	Москва (495)268-04-70	Ростов-на-Дону (863)308-18-15	Тверь (4822)63-31-35
Астрахань (8512)99-46-04	Казань (843)206-01-48	Мурманск (8152)59-64-93	Рязань (4912)46-61-64	Томск (3822)98-41-53
Барнаул (3852)73-04-60	Калининград (4012)72-03-81	Набережные Челны (8552)20-53-41	Самара (846)206-03-16	Тула (4872)74-02-29
Белгород (4722)40-23-64	Калуга (4842)92-23-67	Нижний Новгород (831)429-08-12	Санкт-Петербург (812)309-46-40	Тюмень (3452)66-21-18
Брянск (4832)59-03-52	Кемерово (3842)65-04-62	Новокузнецк (3843)20-46-81	Саратов (845)249-38-78	Ульяновск (8422)24-23-59
Владивосток (423)249-28-31	Киров (8332)68-02-04	Новосибирск (383)227-86-73	Севастополь (8692)22-31-93	Уфа (347)229-48-12
Волгоград (844)278-03-48	Краснодар (861)203-40-90	Омск (3812)21-46-40	Симферополь (3652)67-13-56	Хабаровск (4212)92-98-04
Вологда (8172)26-41-59	Красноярск (391)204-63-61	Орел (4862)44-53-42	Смоленск (4812)29-41-54	Челябинск (351)202-03-61
Воронеж (473)204-51-73	Курск (4712)77-13-04	Оренбург (3532)37-68-04	Сочи (862)225-72-31	Череповец (8202)49-02-64
Екатеринбург (343)384-55-89	Липецк (4742)52-20-81	Пенза (8412)22-31-16	Ставрополь (8652)20-65-13	Ярославль (4852)69-52-93
Иваново (4932)77-34-06	Киргизия (996)312-96-26-47	Казахстан (772)734-952-31	Таджикистан (992)427-82-92-69	

Единый адрес для всех регионов: bda@nt-rt.ru || www.bodysolid.nt-rt.ru

	Qty.
A1. M10X115L HEX HEAD BOLT-----	[1PCS]
A2. M10X110L HEX HEAD BOLT-----	[1PCS]
A3. M10X90L HEX HEAD BOLT-----	[2PCS]
A4. M10X70L HEX HEAD BOLT-----	[12PCS]
A5. M10X40L HEX HEAD BOLT-----	[6PCS]
A6. 5/16"X2 3/4" HEX HEAD BOLT-----	[4PCS]
A7. M10X70L CARRIAGE BOLT-----	[2PCS]
A8. EXTERNALLY THREADED SHAFT (8260-006)--	[1PCS]
A9. CAP 3/8"X3 1/2" ROUNT BOLT-----	[1PCS]
B1. M10 NYLON LOCK NUT-----	[23PCS]
B2. 1/2" LOCK NUT-----	[1PCS]
B3. 3/8" NYLON LOCK NUT-----	[1PCS]
C1. M10 (I.D)WASHER-----	[14PCS]
C2. 5/16" (I.D)WASHER-----	[4PCS]
C3. 5/16" SPRING WASHER-----	[4PCS]
C4. M10 ROUND END CAP WASHER-----	[2PCS]
C5. 1/2" SPRING WASHER-----	[1PCS]
C6. M10XØ19 (I.D) WASHER-----	[2PCS]

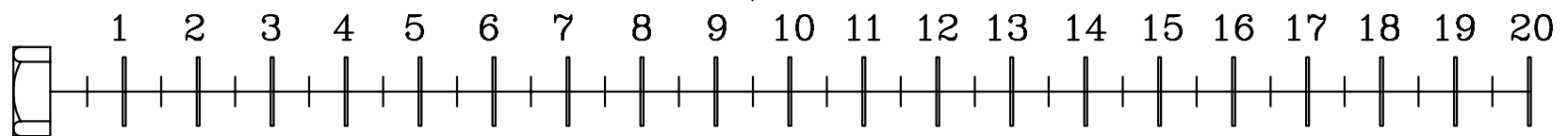
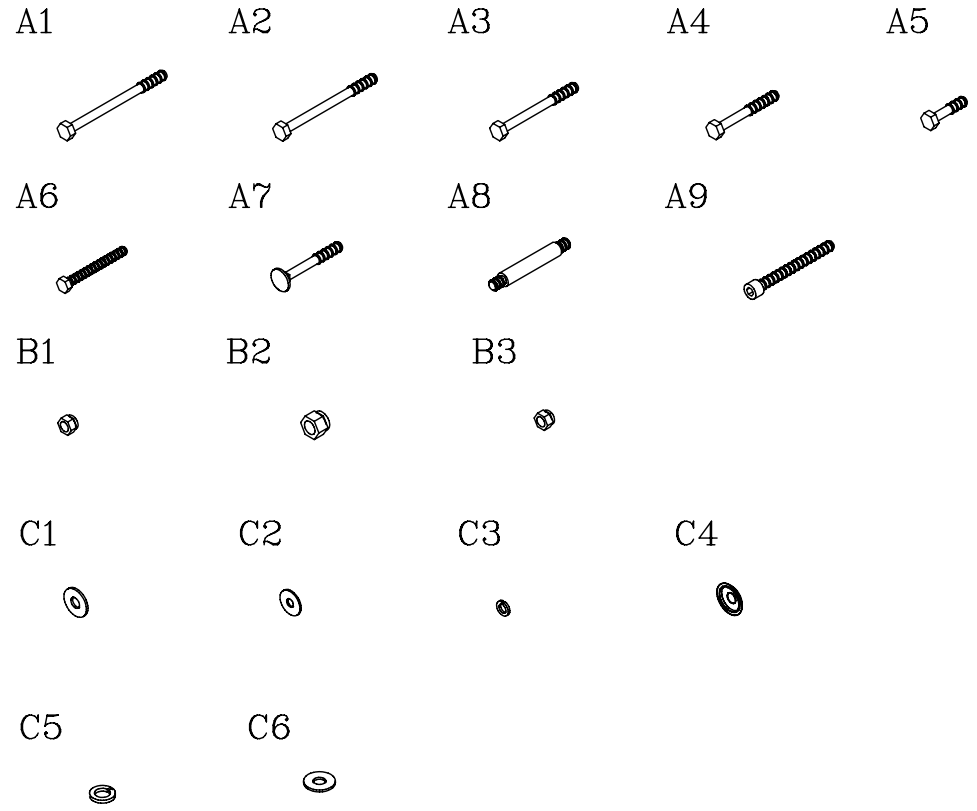

	Qty.
D1. M10 BOLT CAP (9212-026) -----	[2PCS]
D2. 50X50 FOOT CAP (9212-003) -----	[2PCS]
D3. 50X1.8t END CAP (9211-005)-----	[8PCS]
D4. 45X45 END CAP (9211-004)-----	[1PCS]
D5. 38X38 END CAP (9211-003)-----	[2PCS]
D6. $\phi 25.4$ ROUND END CAP (9211-016)-----	[5PCS]
D7. $\phi 74$ mm PULLEY (9213-005)-----	[14PCS]
D8. SELECTOR SHAFT (8210-052)-----	[1PCS]
D9. $\phi 2 \frac{1}{2}$ "X $\phi 26$ RUBBER DOUNT(9310-012)---	[2PCS]
D11. $\phi 25.4$ RUBBER DOUNT (9212-019)-----	[1PCS]
D13. $\phi 6$ mm SPRING SNAP LINK (8810-002)---	[3PCS]
D14. $\phi 16$ STEEL BUSHING (9211-041)-----	[8PCS]
D15. $\phi 1$ "X34X135 RUBBER GRIP (9212-016)----	[6PCS]
D16. $\phi 3 \frac{1}{2}$ "X8" FOAM ROLLER (9161-007)----	[4PCS]
D17. $\phi 4$ "X10" FOAM ROLLER (9161-010)-----	[2PCS]
D18. $\phi 2 \frac{1}{2}$ "X $\phi 19.2$ RUBBER DOUNT (9310-010)	[4PCS]
D19. $\phi 3/4$ " SHAFT CLOOAR (9211-046)-----	[2PCS]
D20. 3380mm STEEL CABLE-----	[1PCS]
D21. 3050mm STEEL CABLE-----	[1PCS]
D22. 3790mm STEEL CABLE-----	[1PCS]

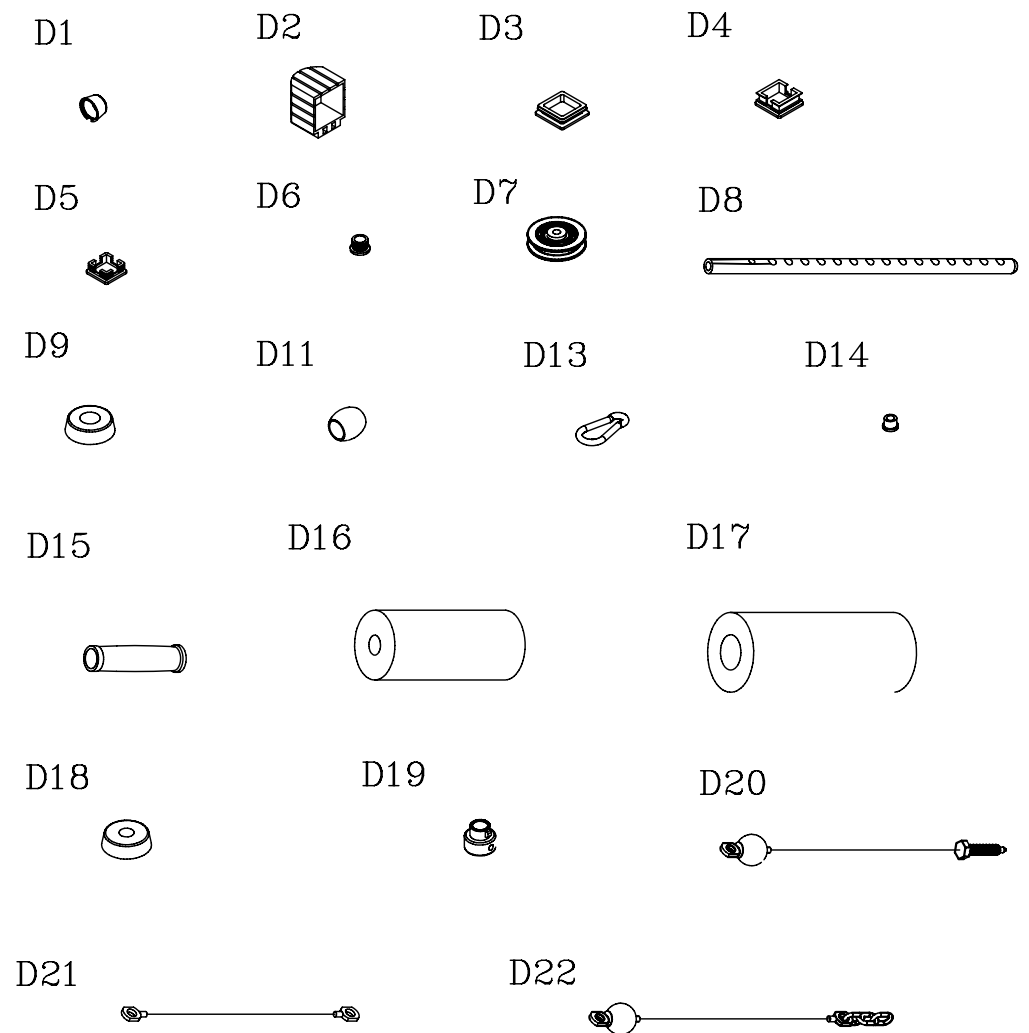

A [1PCS]

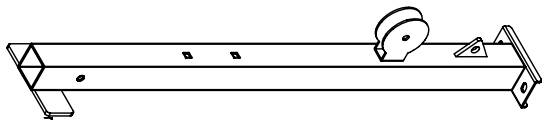

J [1PCS]

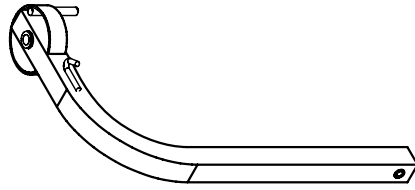

K [1PCS]

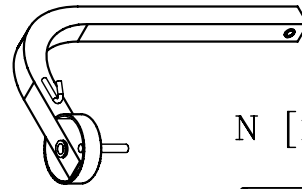

L [2PCS]



M [2PCS]

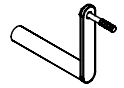

B [1PCS]

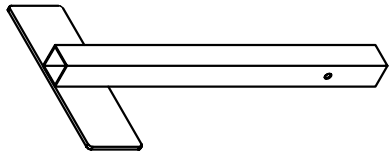

D [1PCS]

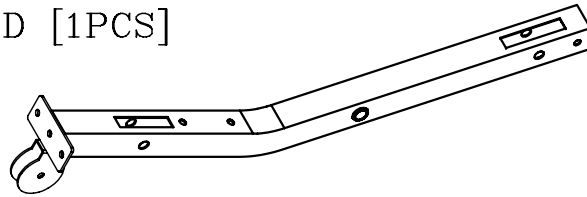

N [1PCS]



O [2PCS]

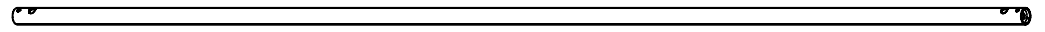

C [1PCS]

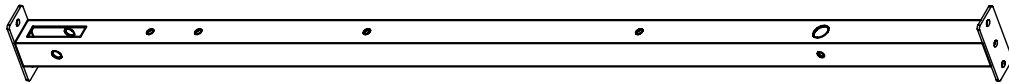

P [1PCS]



Q [1PCS]



R [1PCS]

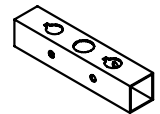

E [1PCS]

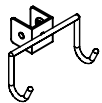

G [1PCS]

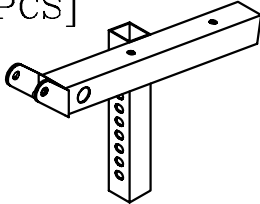

S [1PCS]

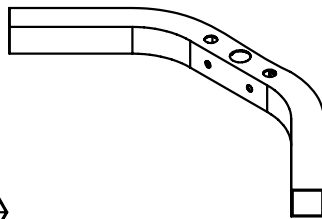

U [1PCS]



V [2PCS]

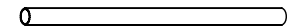

F [1PCS]

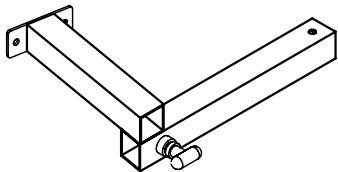

H [1PCS]

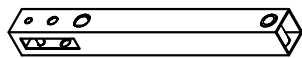

T [1PCS]

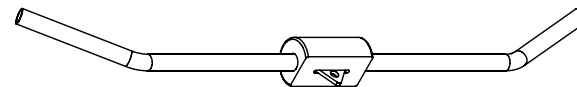

W [1PCS]

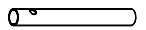

I [1PCS]

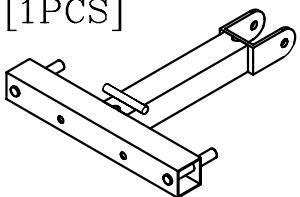

X [1PCS]

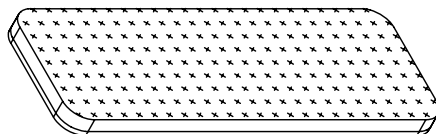

Y [1PCS]

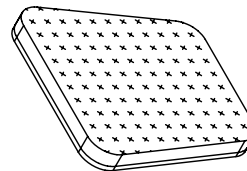

Z [1PCS]



AA [1PCS]



PHG-1000

M10X16L ROUND INNER HEX SCREW

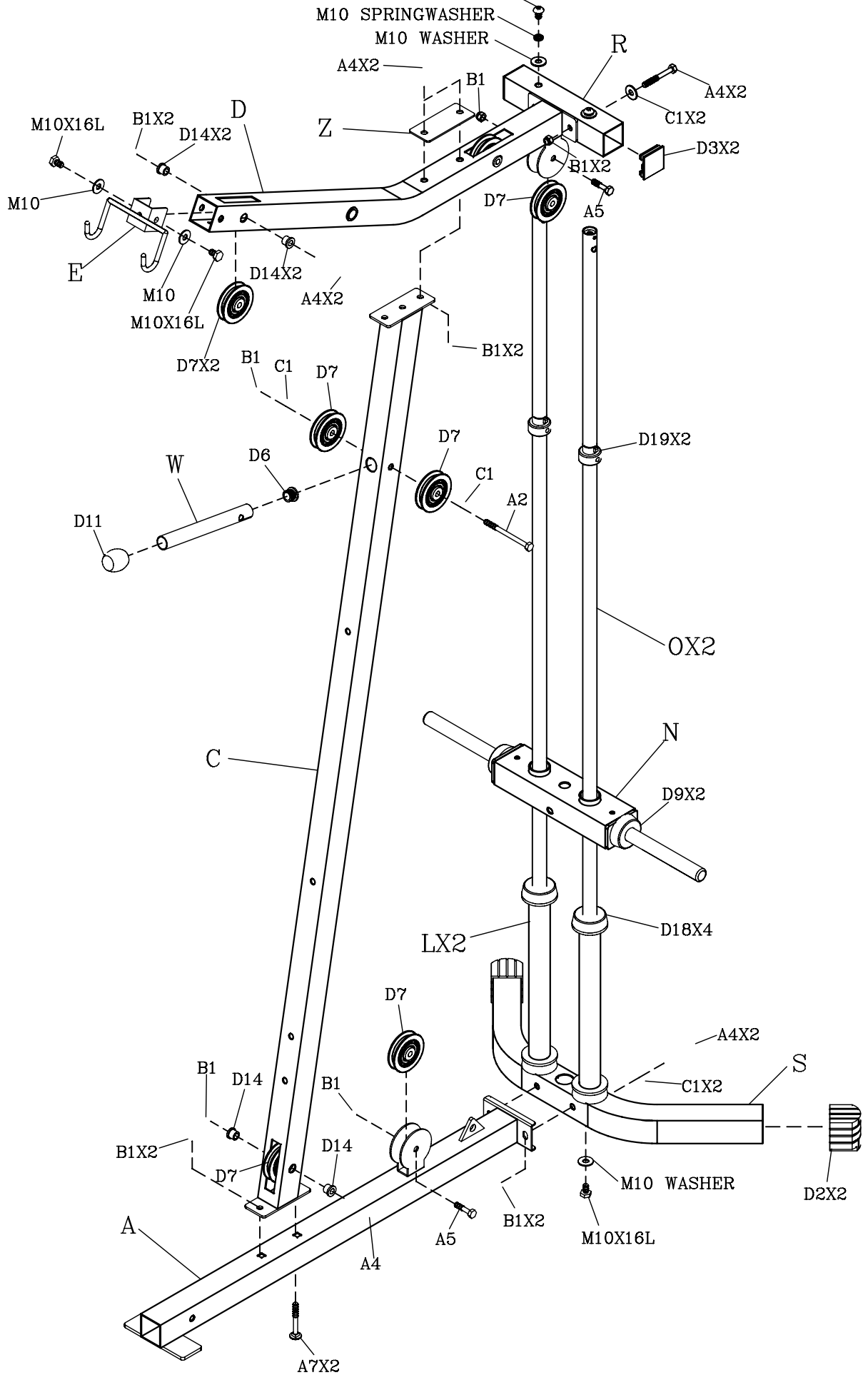

PHG-1000

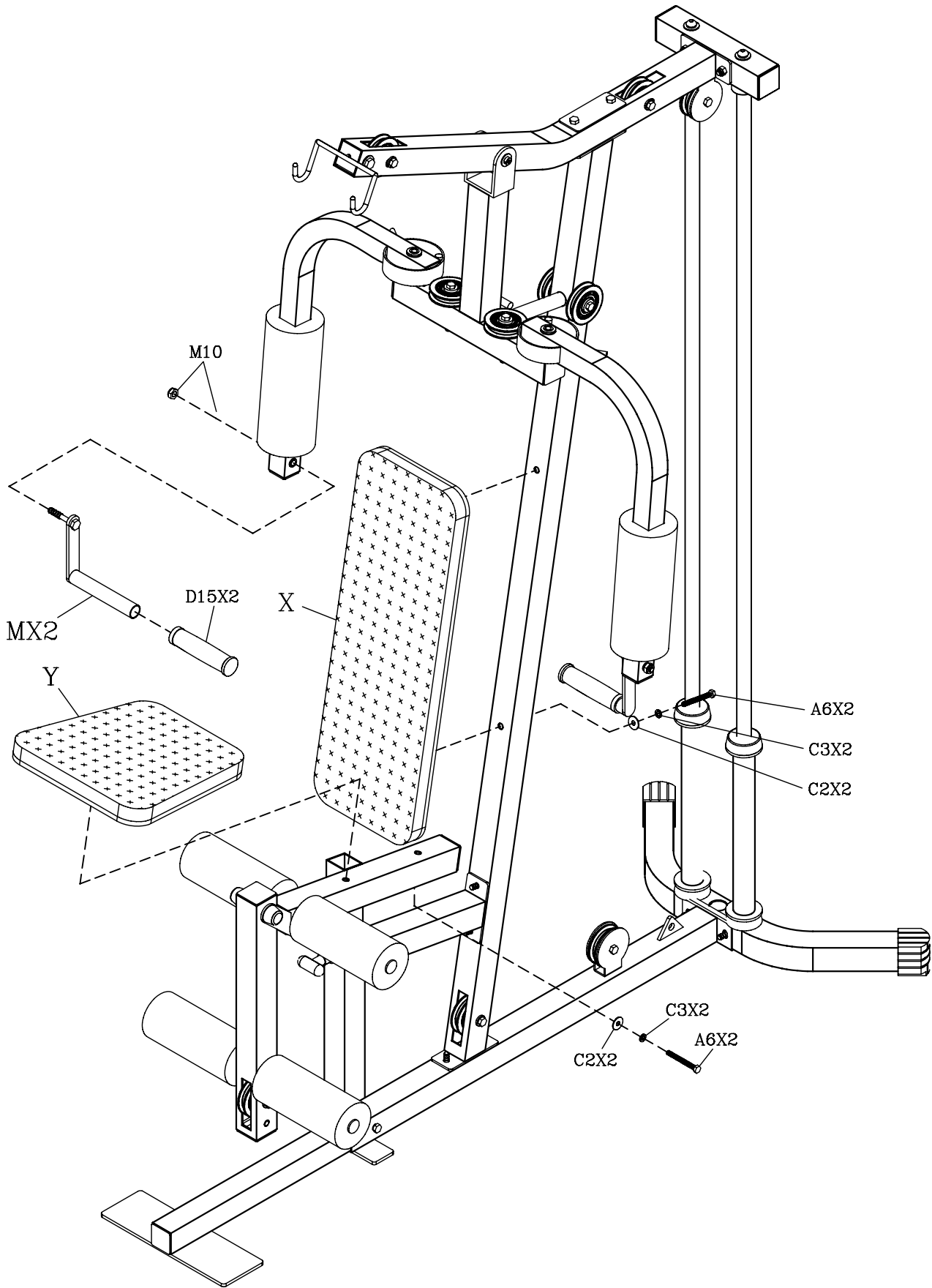

PHG-1000

