

## **Инструкция**

### **Верхняя тяга Body Solid GLA378 для силовой рамы GPR378**

Полезные ссылки:

[Верхняя тяга Body Solid GLA378 для силовой рамы GPR378 - смотреть на сайте](#)

# **USER'S MANUAL**

## **GPR378**

# GPR378 EXPLODED DIAGRAM

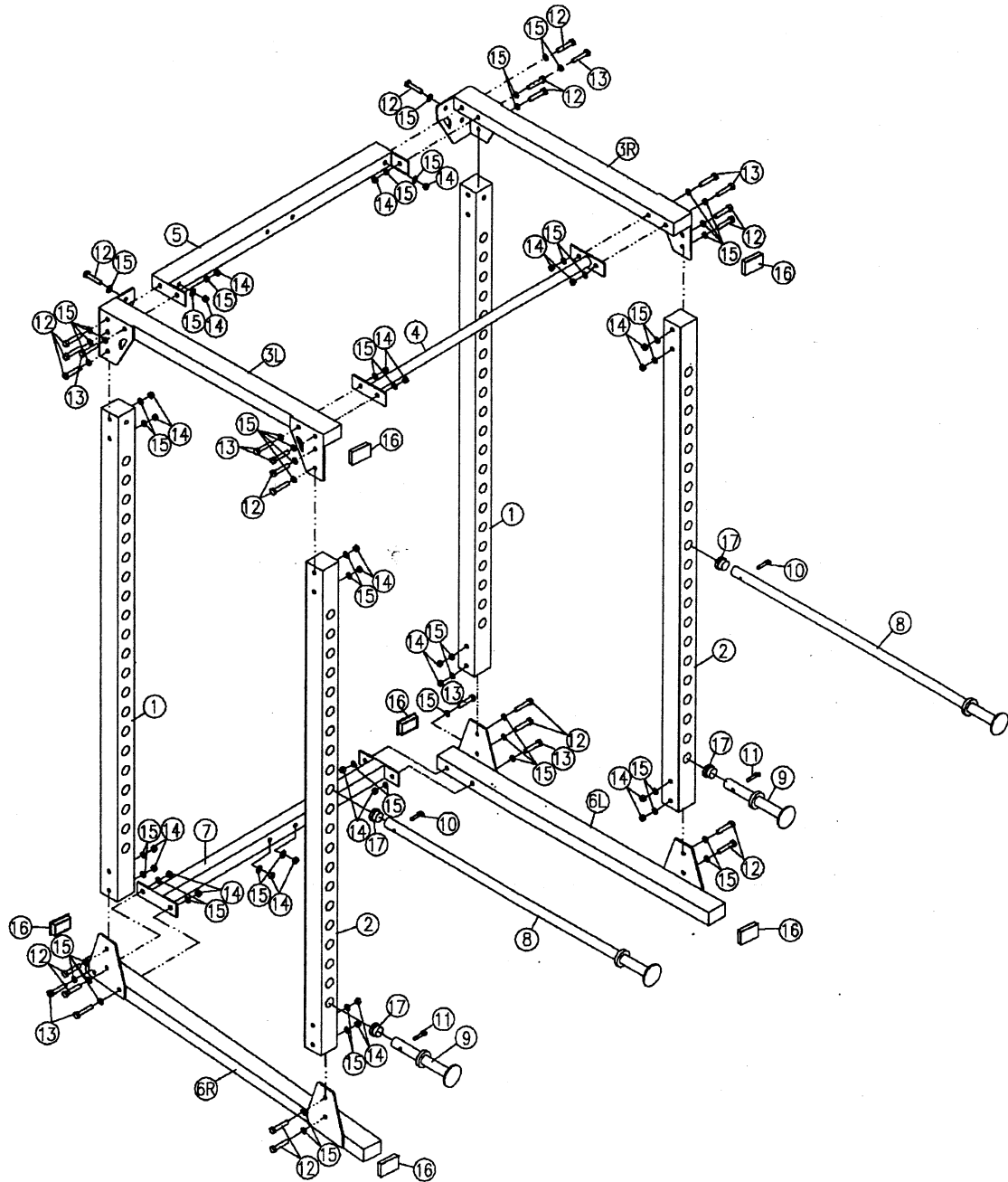

## GPR378 PART LIST

NO.	NAMES	QTY.
1	BACK UPRIGHT	2
2	FRONT UPRIGHT	2
3	SIDE TOP FRAME	2
4	CHIN UP BAR	1
5	REAR TOP FRAME	1
6	SIDE BOTTOM FRAME	1
7	REAR BOTTOM FRAME	1
8	SAFETY CATCH	2
9	LIFT OFF	2
10	RING PIN 5/16"dia.×1 3/4" Length	2
11	RING PIN 3/8"dia.×1 3/4" Length	2
12	HEX HEAD BOLT 1/2"×4" PART.THR	20
13	HEX HEAD BOLT 1/2"×4 1/8" PART.THR	10
14	1/2"NYLON LOCK NUT	30
15	1/2" WASHER	60
16	END CAP 3"×2"	6
17	ROUND END CAP 1 1/4"dia.	4

**STEP 1**

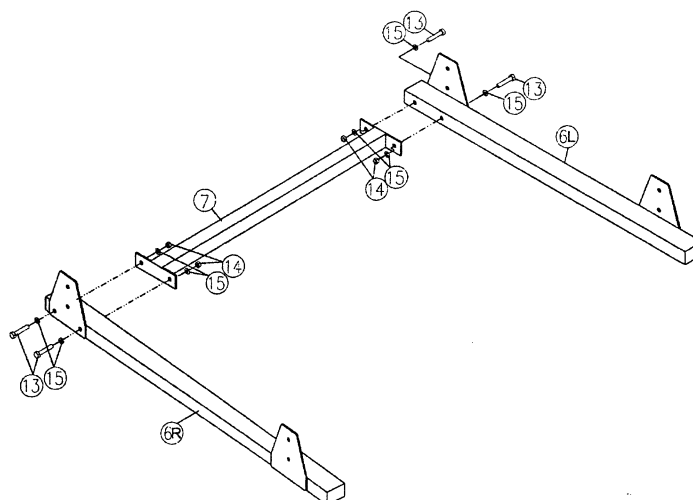

**STEP 2**

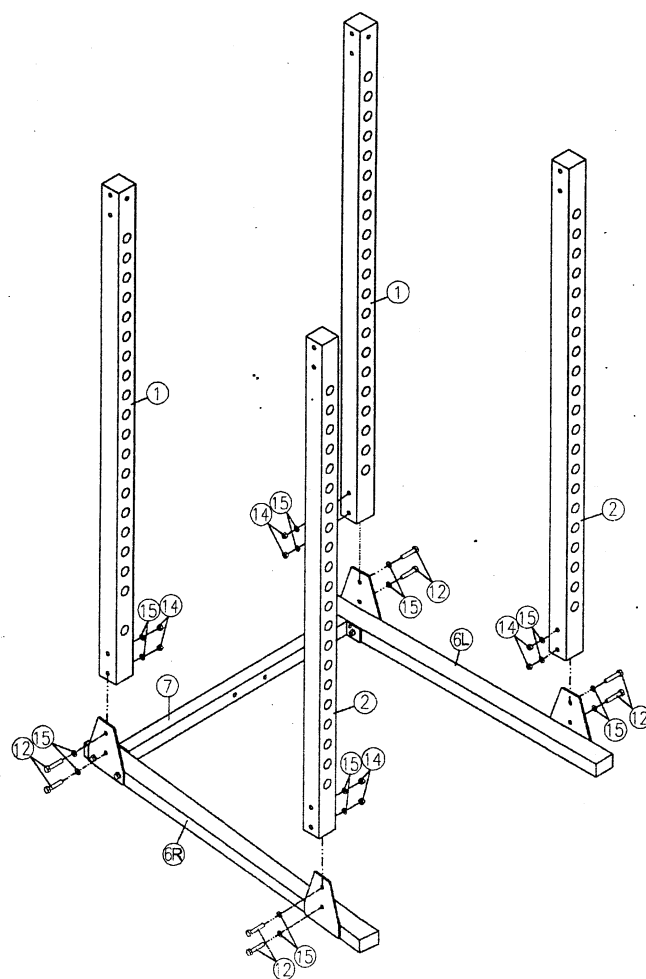

### STEP 3

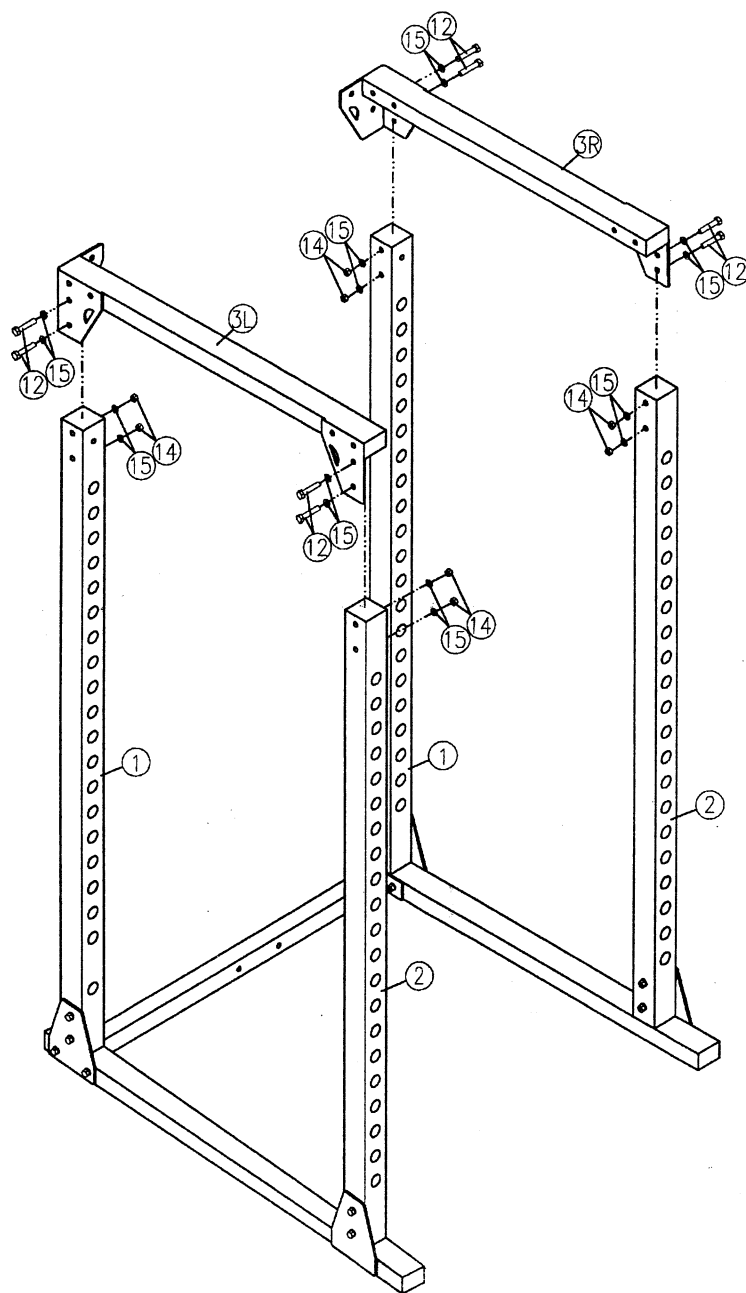

STEP 4

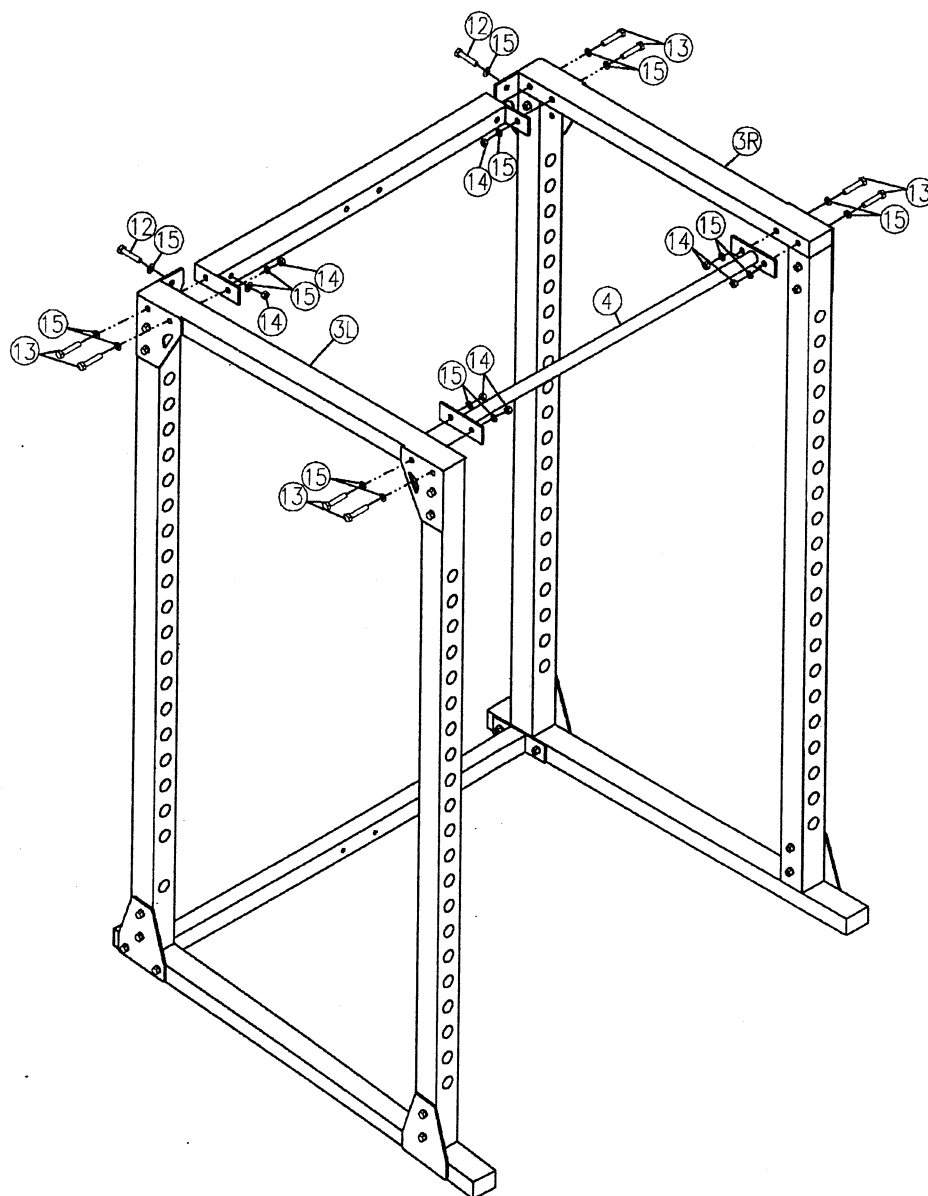

# STEP 5

